

CUMHURBAŞKANI KARARI



Karar Sayısı: 10972

Adana, Afyonkarahisar, Antalya, Artvin, Balıkesir, Bingöl, Bursa, Çorum, Eskişehir, Gaziantep, Gümüşhane, İzmir, Karabük, Kastamonu, Kütahya, Mersin, Muğla, Samsun, Tokat, Trabzon ve Yalova illerinde bulunan bazı alanların orman sınırları dışına çıkartılması hakkındaki ekli Kararın yürürlüğe konulmasına, 6831 sayılı Orman Kanununun ek 16 ncı maddesi gereğince karar verilmiştir.

26 Şubat 2026

Recep Tayyip ERDOĞAN
CUMHURBAŞKANI

26/2/2026 TARİHLİ VE 10972 SAYILI CUMHURBAŞKANI KARARININ EKİ
KARAR

Orman sınırı dışına çıkartılan alanlar

MADDE 1- (1) Adana, Afyonkarahisar, Antalya, Artvin, Balıkesir, Bingöl, Bursa, Çorum, Eskişehir, Gaziantep, Gümüşhane, İzmir, Karabük, Kastamonu, Kütahya, Mersin, Muğla, Samsun, Tokat, Trabzon ve Yalova illerinde bulunan ve ekli krokiler ile listelerde sınır ve koordinatları gösterilen alanların orman sınırları dışına çıkartılmasına karar verilmiştir.

(2) Birinci fıkra kapsamında orman sınırları dışına çıkartılan alanların iki katından az olmamak üzere Devletin hüküm ve tasarrufu altında veya Hazinesinin özel mülkiyetinde bulunan taşımazlardan Çevre, Şehircilik ve İklim Değişikliği Bakanlığı (Milli Emlak Genel Müdürlüğü) tarafından Orman Genel Müdürlüğüne orman tesis etmek üzere tahsis yapılır.

Yürürlük

MADDE 2- (1) Bu Karar yayımı tarihinde yürürlüğe girer.

Yürütme

MADDE 3- (1) Bu Karar hükümlerini Cumhurbaşkanı yürütür.

İli : ADANA
İlçesi : TUFANBEYLİ
Mahallesi : ŞAR

RÖLEVE KROKİSİ

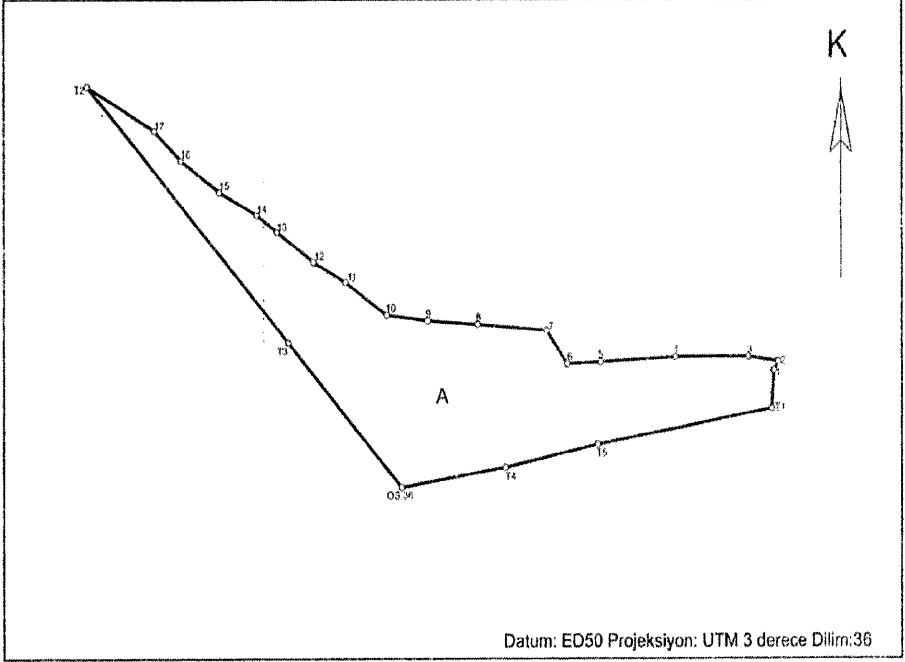

Datum: ED50 Projeksiyon: UTM 3 derece Dilim:36

Ada	Parsel	Noktalar	HesapAlan
104	105-A	10,9,8,7,6,5,4,3,2,1,T1,T5,T4, OS.36,T3,T2,17,16,15,14,13,12, 11	1234.33

NoktaNo	Y	X	NoktaNo	Y	X
1	532522.32	4246212.43	2	532522.98	4246213.58
3	532518.49	4246214.20	4	532507.57	4246214.16
5	532496.36	4246213.52	6	532491.33	4246213.29
7	532488.20	4246217.63	8	532477.80	4246218.39
9	532470.33	4246218.90	10	532464.27	4246219.60
11	532458.05	4246223.89	12	532453.21	4246226.48
13	532447.67	4246230.37	14	532444.64	4246232.53
15	532439.06	4246235.46	16	532433.26	4246239.55
17	532429.26	4246243.38	OS.36	532466.45	4246197.39
T1	532522.04	4246207.50	T2	532419.19	4246249.12
T3	532449.43	4246216.09	T4	532482.03	4246199.92
T5	532495.93	4246202.87			

İli : ADANA
İlçesi : TUFANBEYLİ
Mahallesi : ŞAR

RÖLEVE KROKİSİ

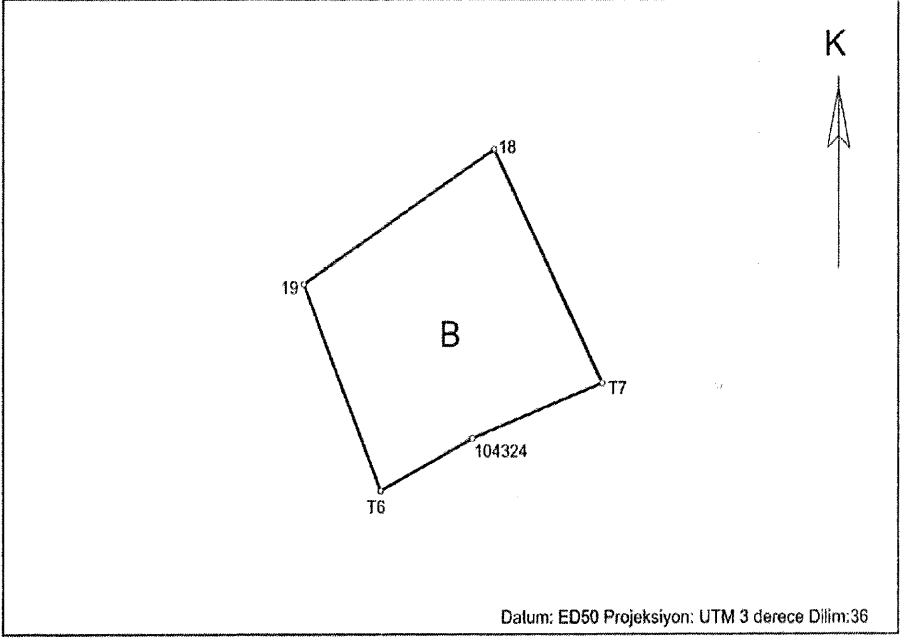

Ada	Parsel	Noktalar	HesapAlan
104	105-B	104324,T6,19,18,T7	367.72

NoktaNo	Y	X	NoktaNo	Y	X
18	533419.03	4246572.12	19	533402.62	4246561.80
104324	533417.16	4246550.02	T6	533409.26	4246546.02
T7	533428.41	4246554.25			

İli : AFYONKARAHİSAR
İlçesi : İHSANİYE
Köyü : YEŞİLYAYLA

RÖLEVE KROKİSİ

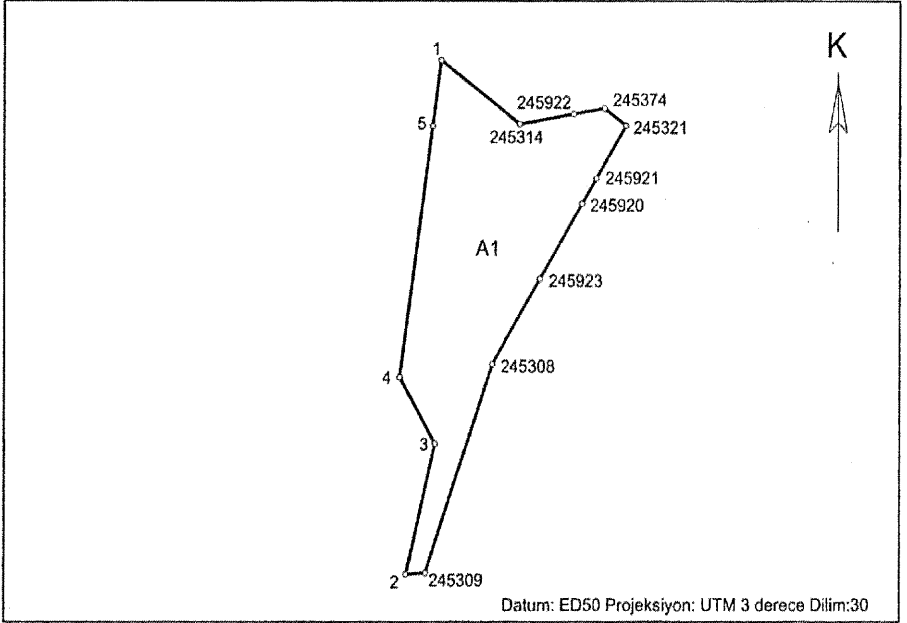

Ada	Parsel	Noktalar	HesapAlan
245	60-A1	245920,245923,245308,245309,2,3,4,5,1,245314,245922,245374,245321,245921	5003.20

NoktaNo	Y	X	NoktaNo	Y	X
1	548266.80	4322256.07	2	548254.86	4322094.64
3	548264.80	4322135.64	4	548252.66	4322156.49
5	548263.87	4322235.40	245308	548284.50	4322160.52
245309	548261.47	4322095.08	245314	548293.99	4322236.00
245321	548330.47	4322235.48	245374	548323.06	4322240.98
245920	548315.43	4322210.96	245921	548320.34	4322218.97
245922	548312.52	4322239.17	245923	548300.94	4322187.34

İli : AFYONKARAHİSAR
İlçesi : İHSANİYE
Köyü : YEŞİLYAYLA

RÖLEVE KROKİSİ

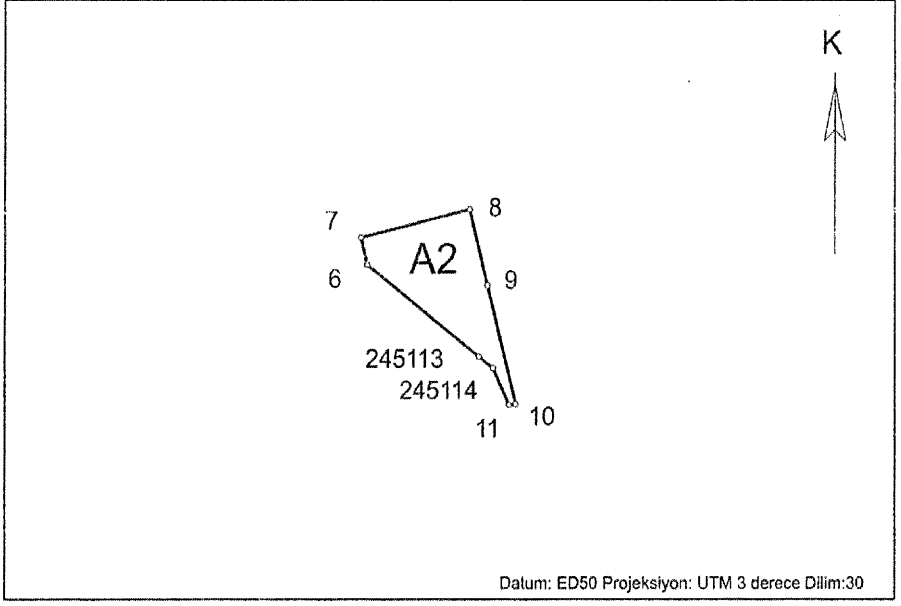

Datum: ED50 Projeksiyon: UTM 3 derece Dilim:30

Ada	Parsel	Noktalar	HesapAlan
245	614-A2	9,10,11,245114,245113,6,7,8	83.23

NoktaNo	Y	X	NoktaNo	Y	X
6	548546.07	4322489.32	7	548545.53	4322491.51
8	548554.95	4322493.80	9	548556.48	4322487.63
10	548558.94	4322477.97	11	548558.35	4322477.93
245113	548555.75	4322481.84	245114	548556.96	4322480.90

İli : ANTALYA
İlçesi : GAZİPAŞA
Mahallesi : ÜÇKONAK

RÖLEVE KROKİSİ

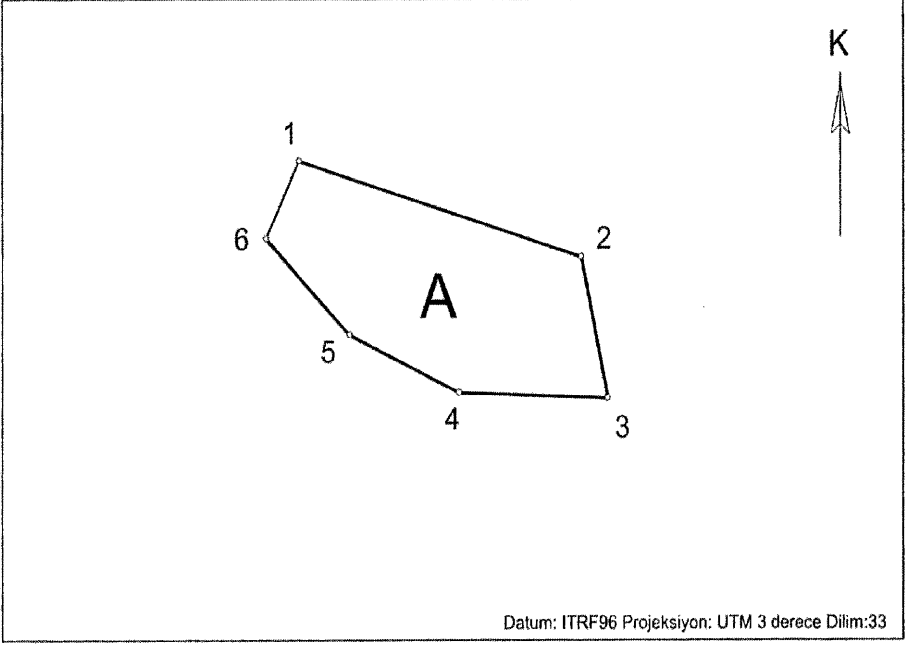

Ada	Parsel	Noktalar	HesapAlan
A		3,4,5,6,1,2	679.47

NoktaNo	Y	X	NoktaNo	Y	X
1	455315.81	4016075.17	2	455351.29	4016064.38
3	455354.62	4016048.62	4	455335.93	4016049.24
5	455322.25	4016055.68	6	455311.60	4016066.45

İli : ANTALYA
İlçesi : MANAVGAT
Mahallesi : GEBECE

RÖLEVE KROKİSİ

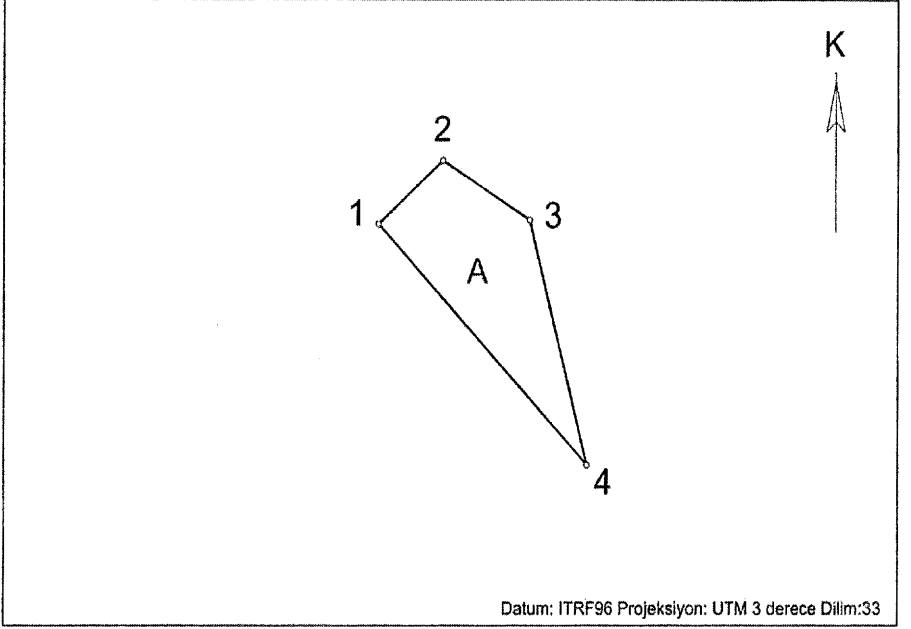

Ada	Parsel	Noktalar	HesapAlan
A		4,1,2,3	340.54

NoktaNo	Y	X	NoktaNo	Y	X
1	380151.63	4082666.61	2	380159.83	4082673.84
3	380170.89	4082667.08	4	380178.21	4082638.92

İli : ANTALYA
İlçesi : MANAVGAT
Mahallesi : KARABÜK

RÖLEVE KROKİSİ

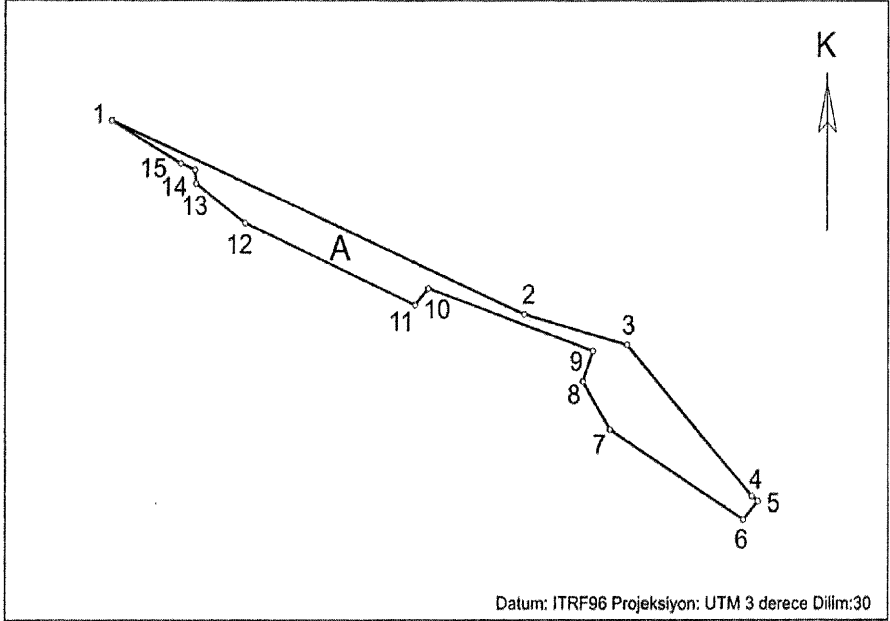

Datum: ITRF96 Projeksiyon: UTM 3 derece Dilim:30

Ada	Parsel	Noktalar	HesapAlan
A		10,11,12,13,14,15,1,2,3,4,5,6,7,8,9	1093.64

NoktaNo	Y	X	NoktaNo	Y	X
1	607335.98	4110696.18	2	607431.39	4110655.90
3	607455.15	4110649.55	4	607483.90	4110618.04
5	607485.29	4110617.05	6	607481.90	4110613.18
7	607451.22	4110631.94	8	607444.96	4110641.97
9	607447.34	4110648.27	10	607409.23	4110661.31
11	607406.20	4110657.85	12	607366.81	4110674.76
13	607355.43	4110683.00	14	607355.17	4110685.85
15	607351.90	4110687.19			

İli : ANTALYA
İlçesi : MANAVGAT
Mahallesi : KIZILDAĞ

RÖLEVE KROKİSİ

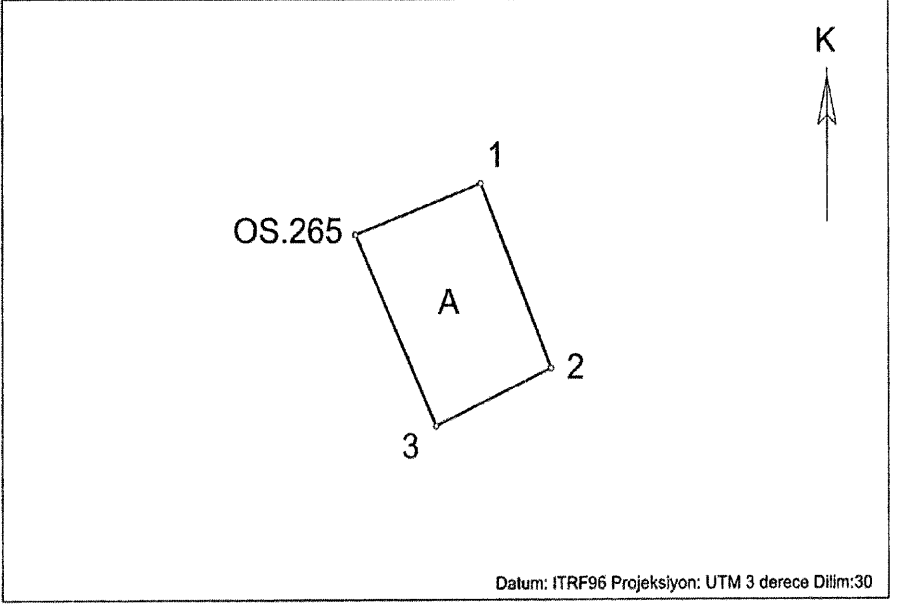

Ada	Parsel	Noktalar	HesapAlan
A		OS.265,1,2,3	411.46

NoktaNo	Y	X	NoktaNo	Y	X
1	617614.96	4101321.20	2	617624.03	4101299.09
3	617609.18	4101292.19	OS.265	617598.86	4101315.14

İli : ANTALYA
İlçesi : MANAVGAT
Mahallesi : TİLKİLER

RÖLEVE KROKİSİ

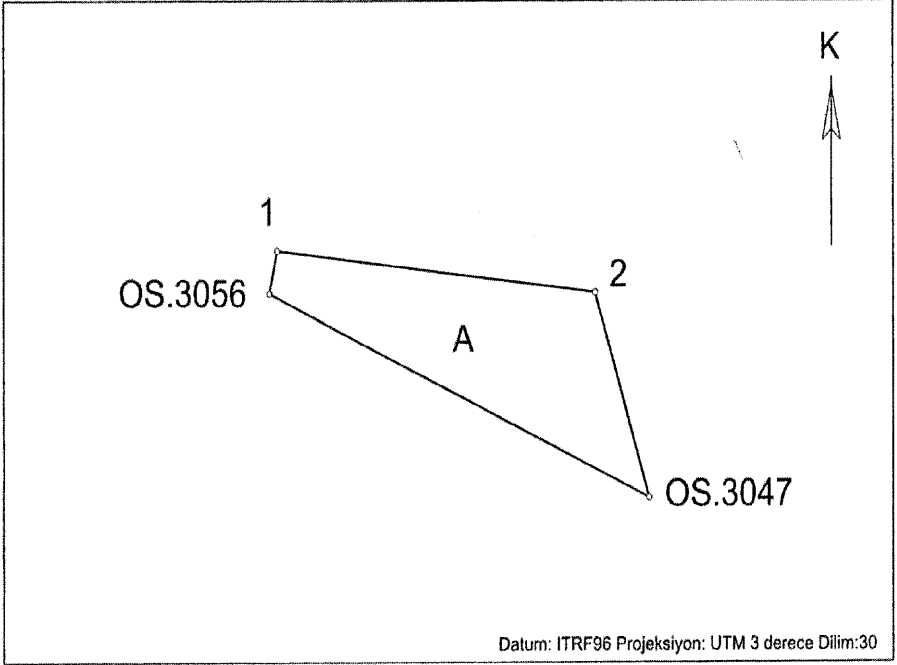

Ada	Parsel	Noktalar	HesapAlan
A		OS.3047,OS.3056,1,2	559.93

NoktaNo	Y	X	NoktaNo	Y	X
1	631671.62	4090243.84	2	631712.27	4090239.30
OS.3047	631719.11	4090217.06	OS.3056	631670.62	4090239.21

İli : Antalya
İlçesi : Korkuteli
Mahallesi : Uzunoluk

KOORDİNELİ ÖZET ALAN ÇİZELGESİ

Datum: ITRF96 Projeksiyon: UTM 3 derece Dilim:30

Nokta No	Y	X	Nokta No	Y	X	Nokta No	Y	X
1	520020.09	4107368.83	2	520109.45	4107304.23	3	520138.24	4107159.51
4	520213.10	4107091.45	5	520277.79	4107069.73	6	520315.83	4106776.14
7	520481.53	4106494.37	8	520788.47	4106059.32	9	520965.31	4105776.19
10	521000.05	4105495.86	11	521026.35	4105439.20	12	521030.35	4105422.41
13	520945.19	4105361.17	14	520830.24	4105278.49	15	520786.77	4105384.90
16	520713.97	4105538.67	17	520788.56	4105464.40	18	520658.54	4105270.40
19	520661.55	4105777.86	20	520623.40	4105866.30	21	520334.02	4105975.84
22	520293.70	4106088.56	23	520175.97	4106125.33	24	519997.58	4106202.10
25	519856.90	4105185.32	26	519613.28	4106258.95	27	519464.30	4106293.89
28	519424.27	4106382.92	29	519421.55	4106581.59	30	519412.05	410581.52
31	519163.50	4106713.52	32	519025.21	4106856.52	33	519043.41	4106580.99
34	519176.69	4106799.19	35	519345.62	4106817.97	36	519355.56	4106866.36
37	519149.22	4107028.88	38	519437.29	4107021.64	39	519492.41	4107247.42
40	519894.80	4107080.01	41	520038.38	4108090.14	42	519982.07	4106838.44
43	519815.46	4107009.42	44	521037.98	4105390.87	45	521054.39	4105279.42
46	51099.80	4105077.34	47	521116.70	4105028.91	48	521160.63	4104983.07
49	521096.17	4104985.29	50	521030.71	4104987.18	51	521070.78	4104989.37
52	521022.32	4104988.02	53	521000.75	4105064.54	54	520870.94	4105178.88
55	520841.90	4105249.94	56	520962.70	4105336.82	57	521097.87	4104984.34
58	521095.10	4104975.56	59	521021.96	4104909.94	60	520940.71	4104850.64
61	520891.91	4104906.19	62	520809.02	4104717.17	63	520873.74	4104615.76
64	520700.13	4104572.09	65	520655.89	4104510.44	66	520627.05	4104421.13
67	520607.83	4104361.14	68	520559.17	4104272.52	69	520503.30	4104203.46
70	520477.32	4104172.48	71	520416.43	4104130.97	72	520322.70	4104084.65
73	520181.82	4104026.91	74	519763.22	4104181.85	75	519734.51	4104235.30
76	519786.58	4104077.77	77	519928.71	4104394.79	78	519874.59	4104505.86
79	519984.37	4104554.07	80	519984.68	4104558.55	81	519968.06	4104558.32
82	520048.65	4104549.15	83	520009.47	4104548.48	84	520085.84	4104549.97
85	520128.50	4104559.38	86	520167.79	4104564.76	87	520201.36	4104575.90
88	520228.79	4104590.89	89	520312.71	4104660.02	90	520312.83	4104641.09
91	520232.35	4104516.57	92	520377.08	4104629.68	93	520329.92	4104636.38
94	520461.83	4104585.53	95	520525.69	4104670.77	96	520539.05	4104669.59
97	520702.69	4104897.55	98	520724.55	4104829.01	99	521026.81	4104927.04
100	521022.60	4104987.02	101	521070.71	4104988.37	102	521090.53	4104986.20
103	520856.64	4104776.03	104	520750.96	4104860.39	105	520734.53	4104688.91
106	520648.95	4104679.81	107	520468.87	4104432.69	108	520399.11	4104185.44
109	520330.96	4104261.19	110	520378.68	4104357.03	111	520091.61	4104515.05
112	520309.43	4104383.14	113	520172.97	4104296.26	114	519133.87	4106199.65
115	519201.73	4106209.81	116	519232.50	4106202.00	117	519226.07	4106197.19
118	519252.81	4106153.83	119	519363.53	4106183.82	120	519442.04	4106145.77
121	519544.12	4106089.31	122	519711.70	4106081.29	123	519887.59	4106074.24
124	520041.73	4106008.59	125	520091.16	4105990.86	126	520157.39	4105855.63
127	520301.21	4105881.50	128	520367.54	4105770.60	129	520370.91	4105636.91
130	520377.58	4105469.47	131	520303.99	4105427.03	132	520307.27	4105282.33
133	520218.20	4105292.59	134	520180.37	4105161.39	135	520331.96	4105022.55
136	520131.45	4104834.45	137	520312.71	4104613.32	138	520288.23	4105011.72
139	520200.96	4104876.82	140	520187.57	4104565.74	141	520128.32	4104560.37
142	520086.68	4104550.96	143	520069.44	4104549.49	144	520084.14	4104550.15
145	519988.17	4104559.31	146	519984.75	4104559.54	147	520005.87	4104864.49
148	519993.56	4104881.74	149	519913.40	4104827.75	150	519781.26	4104988.02
151	519523.31	4105025.02	152	519459.07	4104579.57	153	519423.84	4105191.29
154	519380.16	4105327.88	155	519417.73	4105392.21	156	519222.42	4105613.27
157	519687.63	4105465.32	158	519753.09	4105410.56	159	519757.32	4105415.68
160	519849.59	4105349.92	161	519926.16	4105428.88	162	519845.87	4105482.72
163	519829.41	4105499.37	164	519814.02	4105563.67	165	519768.69	4105334.83
166	519774.30	4105697.86	167	519719.64	4105718.04	168	519775.51	4105273.64
169	519778.10	4105778.57	170	519599.47	4105733.51	171	519388.97	4105814.50
172	519314.62	4105750.35	173	519278.82	4105781.06	174	519579.64	4105791.64
175	519221.30	4105998.54	176	519194.17	4105810.37	177	519147.43	4105855.91
178	519115.01	4105924.75	179	519117.92	4105807.82	180	519125.57	4106021.51
181	519117.18	4106057.69	182	519114.70	4106107.86	183	519114.12	4106140.94
184	519136.82	4106153.59	185	519901.61	4105644.52	186	520141.19	4106261.38
187	520052.87	4105460.85	188	519972.85	4105506.08	189	520119.55	4105279.22
190	520116.40	4105144.46	191	520064.97	4105086.56	192	519993.71	4105195.46

Ada	Parsel	Noktalar	HesapAlan
EK_16		2,3,4,5,6,7,8,9,10,11,12,13, 14, 15,16,17,18,19,20,21,22,23, 24,25,26,27,28,29,30,31,32,33, 34,35,36,37,38,39,1,120,121, 122,123,124,125,126,127,128, 129,130,131,132,133,134,135, 136,137,138,139,140,141,142, 143,144,145,146,147,148,149, 150,151,152,153,154,155,156, 157,158,159,160,161,162,163, 164,165,166,167,168,169,170, 171,172,173,174,175,176,177, 178,179,180,181,182,183,184, 114,115,116,117,118,119,45,46, 47,48,49,50,51,52,53,54,55,56, 44,102,57,58,59,60,61,62,63, 64,65,66,67,68,69,70,71,72,73, 74,75,76,77,78,79,80,81,82,83, 84,85,86,87,88,89,90,91,92,93, 94,95,96,97,98,99,100,101,40, 43,42,41,185,188,187,186,189, 192,191,190,104,103,106,105, 111,113,112,107,110,109,108	2883095.61

İli : ARTVİN
İlçesi : MERKEZ
Mahallesi : SEYİTLER

RÖLEVE KROKİSİ

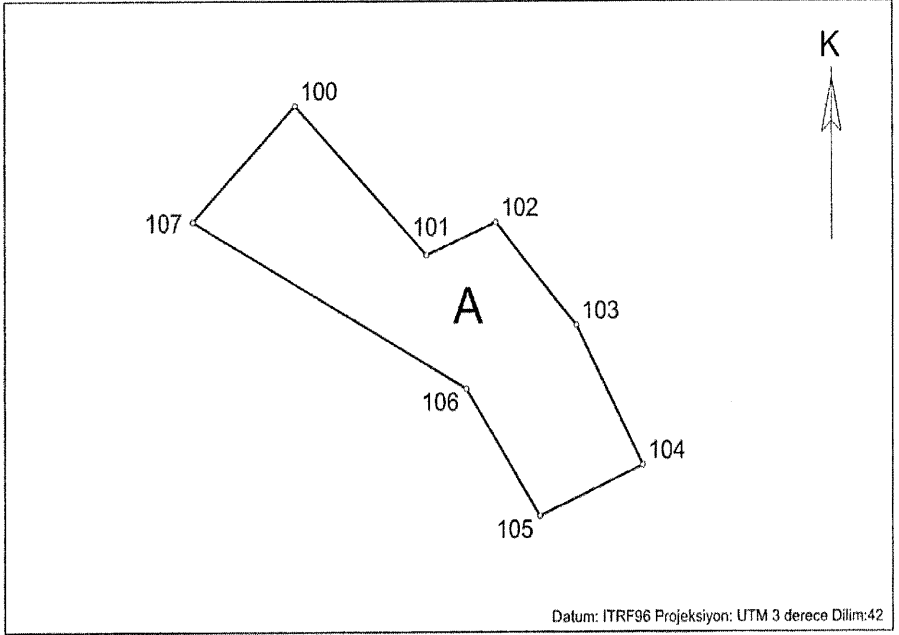

Ada	Parsel	Noktalar	HesapAlan
242	1-A	100,101,102,103,104,105,106, 107	473.74

NoktaNo	Y	X	NoktaNo	Y	X
100	486581.45	4561147.26	101	486593.65	4561134.95
102	486600.13	4561137.66	103	486607.55	4561129.17
104	486613.70	4561117.60	105	486604.22	4561113.44
106	486597.36	4561123.92	107	486571.97	4561137.69

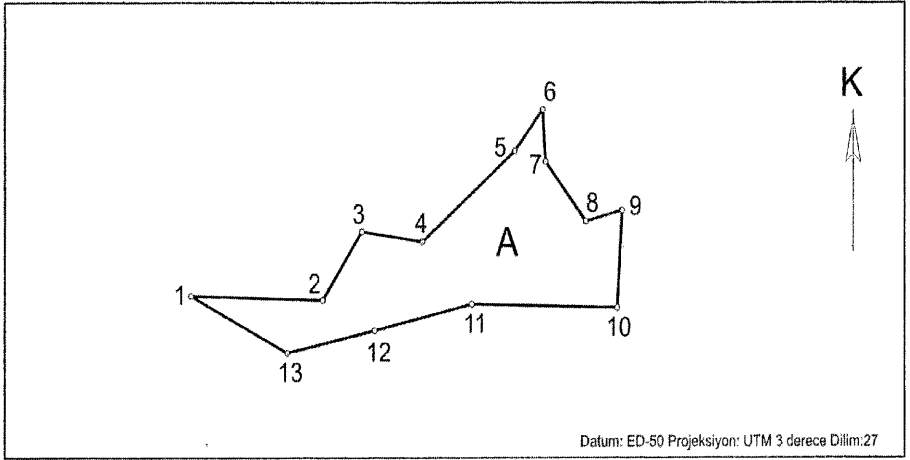

Ada	Parsel	Noktalar	HesapAlan
167	58-A	10,11,12,13,1,2,3,4,5,6,7,8,9	1023.59

NoktaNo	Y	X	NoktaNo	Y	X
1	568805.20	4388533.14	2	568829.51	4388532.46
3	568836.79	4388543.08	4	568847.95	4388541.54
5	568864.92	4388555.57	6	568870.05	4388562.02
7	568870.54	4388553.94	8	568877.93	4388544.68
9	568884.55	4388546.40	10	568883.67	4388531.33
11	568856.99	4388531.87	12	568839.15	4388527.78
13	568822.90	4388524.30			

İli : BİNGÖL

İlçesi : MERKEZ

Köy/Mahalle : KARTAL

RÖLEVE KROKİSİ

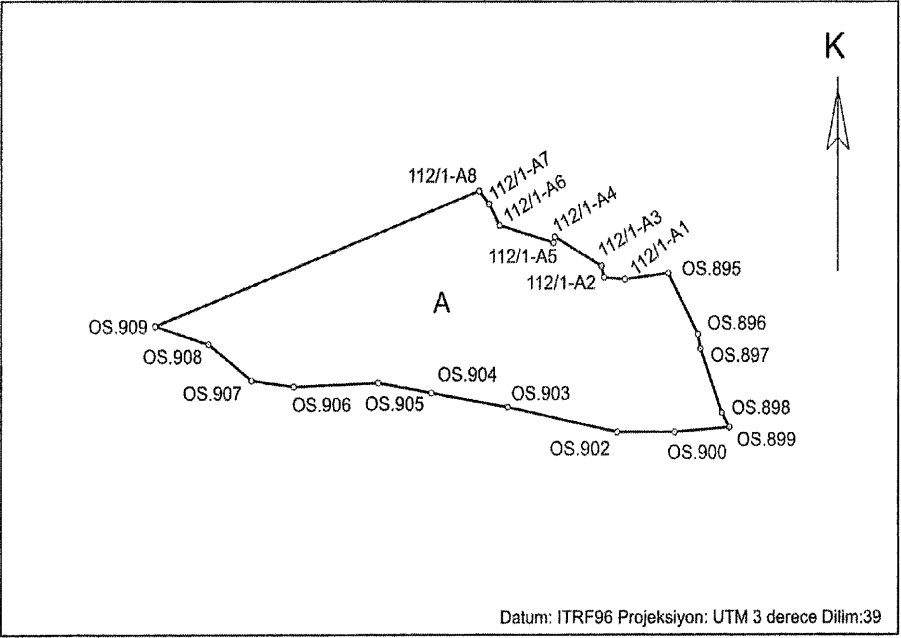

Ada	Parsel	Noktalar	HesapAlan
112	1-A	OS.895,OS.896,OS.897,OS.898, OS.899,OS.900,OS.902,OS.903, OS.904,OS.905,OS.906,OS.907, OS.908,OS.909,112/1-A8, 112/1-A7,112/1-A6,112/1-A5, 112/1-A4,112/1-A3,112/1-A2, 112/1-A1	61121.13

NoktaNo	Y	X	NoktaNo	Y	X
112/1-A1	622033.92	4316103.09	112/1-A2	622014.11	4316104.54
112/1-A3	622011.81	4316114.36	112/1-A4	621967.73	4316139.46
112/1-A5	621966.50	4316134.44	112/1-A6	621914.47	4316149.41
112/1-A7	621904.68	4316167.31	112/1-A8	621895.17	4316178.39
OS.895	622074.89	4316108.30	OS.896	622103.25	4316055.99
OS.897	622105.73	4316043.61	OS.898	622126.04	4315989.02
OS.899	622133.38	4315976.94	OS.900	622081.15	4315972.86
OS.902	622026.73	4315972.86	OS.903	621922.50	4315994.19
OS.904	621849.72	4316006.21	OS.905	621799.00	4316015.00
OS.906	621718.43	4316011.63	OS.907	621678.00	4316016.88
OS.908	621636.75	4316047.68	OS.909	621586.06	4316063.06

İli : BİNGÖL

İlçesi : MERKEZ

Köy/Mahalle : KARTAL

RÖLEVE KROKİSİ

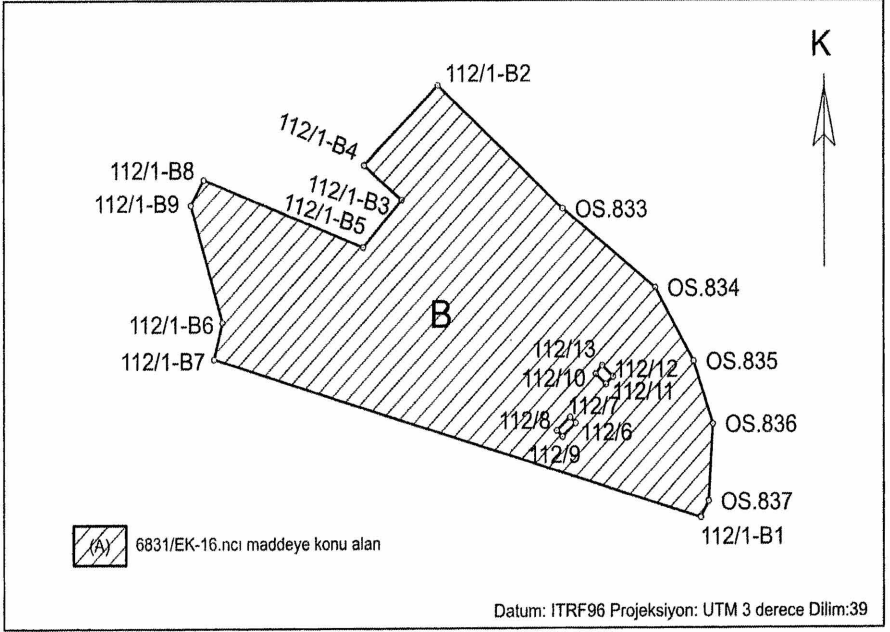

Ada	Parsel	Noktalar	HesapAlan
112	1-B	B6,B9,B8,B5,B3,B4,B2,OS.833, OS.834,OS.835,OS.836,OS.837, B1,B7,112/13,112/10,112/11, 112/12,112/7,112/8,112/9,112/6	10634.95

NoktaNo	Y	X	NoktaNo	Y	X
112/6	623314.07	4316114.44	112/7	623312.28	4316116.12
112/8	623308.06	4316112.28	112/9	623309.86	4316110.53
112/10	623320.48	4316128.40	112/11	623323.81	4316125.49
112/12	623326.13	4316127.63	112/13	623322.60	4316130.79
B1	623354.45	4316087.37	B2	623269.85	4316210.96
B3	623258.35	4316178.25	B4	623246.24	4316188.12
B5	623245.94	4316164.65	B6	623200.34	4316143.26
B7	623197.62	4316132.78	B8	623194.35	4316184.08
B9	623190.17	4316176.76	OS.833	623309.90	4316175.70
OS.834	623339.73	4316152.94	OS.835	623352.13	4316132.03
OS.836	623358.36	4316114.12	OS.837	623356.97	4316092.08

İli : BİNGÖL

İlçesi : MERKEZ

Köy/Mahalle : KARTAL

RÖLEVE KROKISI

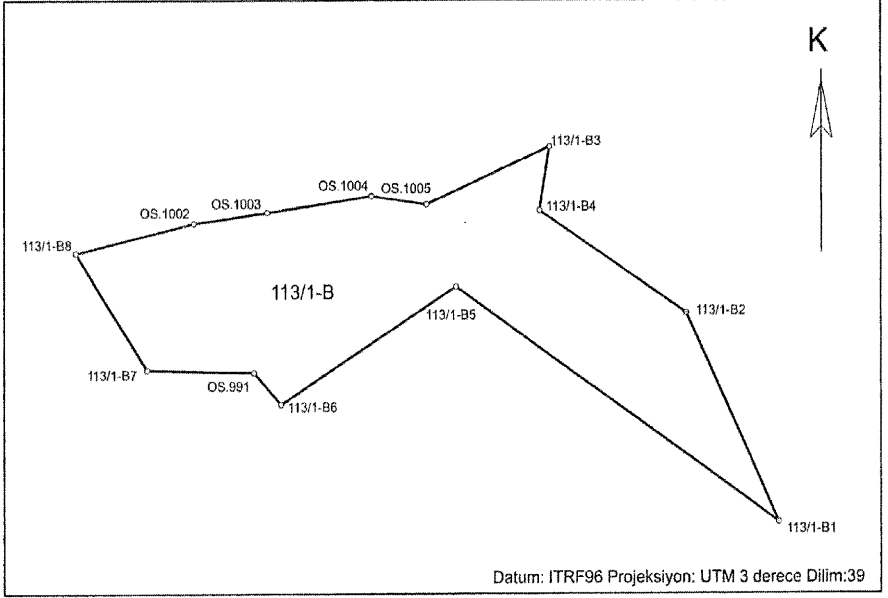

Ada	Parsel	Noktalar	HesapAlan
113	1-B	113/1-B8,OS.1002,OS.1003, OS.1004,OS.1005,113/1-B3, 113/1-B4,113/1-B2,113/1-B1, 113/1-B5,113/1-B6,OS.991, 113/1-B7	16462.16

NoktaNo	Y	X	NoktaNo	Y	X
113/1-B1	623657.33	4315681.19	113/1-B2	623616.18	4315767.44
113/1-B3	623555.79	4315835.99	113/1-B4	623551.29	4315809.82
113/1-B5	623514.09	4315778.34	113/1-B6	623436.90	4315729.69
113/1-B7	623377.63	4315743.96	113/1-B8	623346.09	4315792.24
OS.991	623424.88	4315742.97	OS.1002	623398.35	4315804.52
OS.1003	623430.74	4315808.99	OS.1004	623476.91	4315815.69
OS.1005	623501.12	4315812.34			

İli : BİNGÖL
İlçesi : MERKEZ
Köy/Mahalle : KARTAL

RÖLEVE KROKİSİ

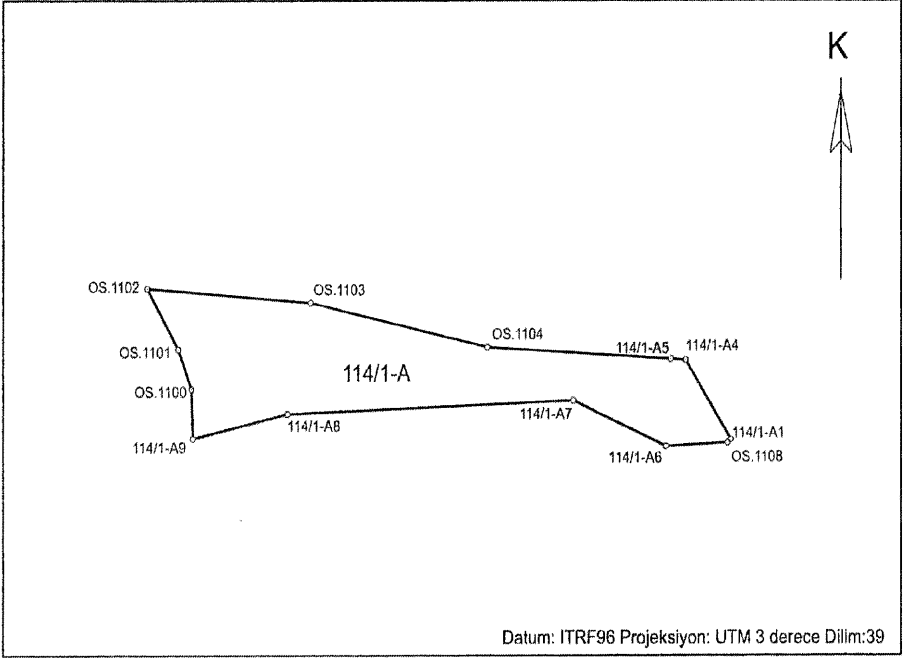

Ada	Parsel	Noktalar	HesapAlan
114	1-A	114/1-A7,114/1-A8,114/1-A9, OS.1100,OS.1101,OS.1102, OS.1103,OS.1104,114/1-A5, 114/1-A4,114/1-A1,OS.1108, 114/1-A6	6970.52

NoktaNo	Y	X	NoktaNo	Y	X
114/1-A1	623380.52	4315706.48	114/1-A4	623361.67	4315735.27
114/1-A5	623355.51	4315735.62	114/1-A6	623353.54	4315704.00
114/1-A7	623315.02	4315720.65	114/1-A8	623195.38	4315715.81
114/1-A9	623155.91	4315706.81	OS.1100	623155.34	4315724.79
OS.1101	623149.86	4315739.04	OS.1102	623137.07	4315761.15
OS.1103	623204.95	4315755.99	OS.1104	623278.99	4315739.87
OS.1108	623379.15	4315705.32			

İli : BİNGÖL
İlçesi : MERKEZ
Köy/Mahalle : KARTAL

RÖLEVE KROKİSİ

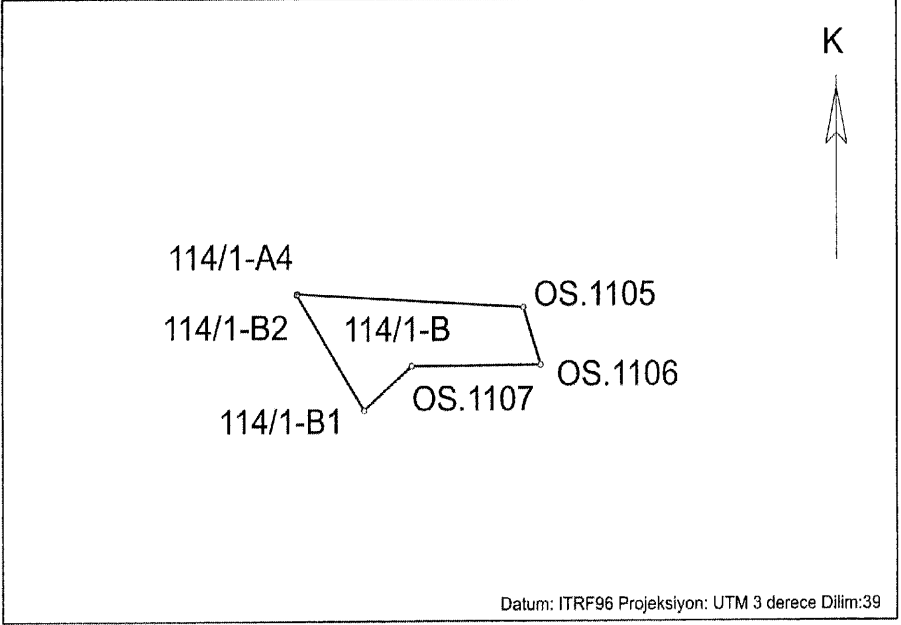

Ada	Parsel	Noktalar	HesapAlan
114	1-B	OS.1107,114/1-B1,114/1-B3, 114/1-B2,OS.1105,OS.1106	437.28

NoktaNo	Y	X	NoktaNo	Y	X
114/1-B1	623391.29	4315715.59	114/1-B2	623379.27	4315734.29
114/1-B3	623379.20	4315734.10	OS.1105	623419.34	4315732.06
OS.1106	623422.36	4315722.85	OS.1107	623399.68	4315722.69

İli : BİNGÖL
İlçesi : MERKEZ
Köy/Mahalle : YUKARIAKPINAR

RÖLEVE KROKİSİ

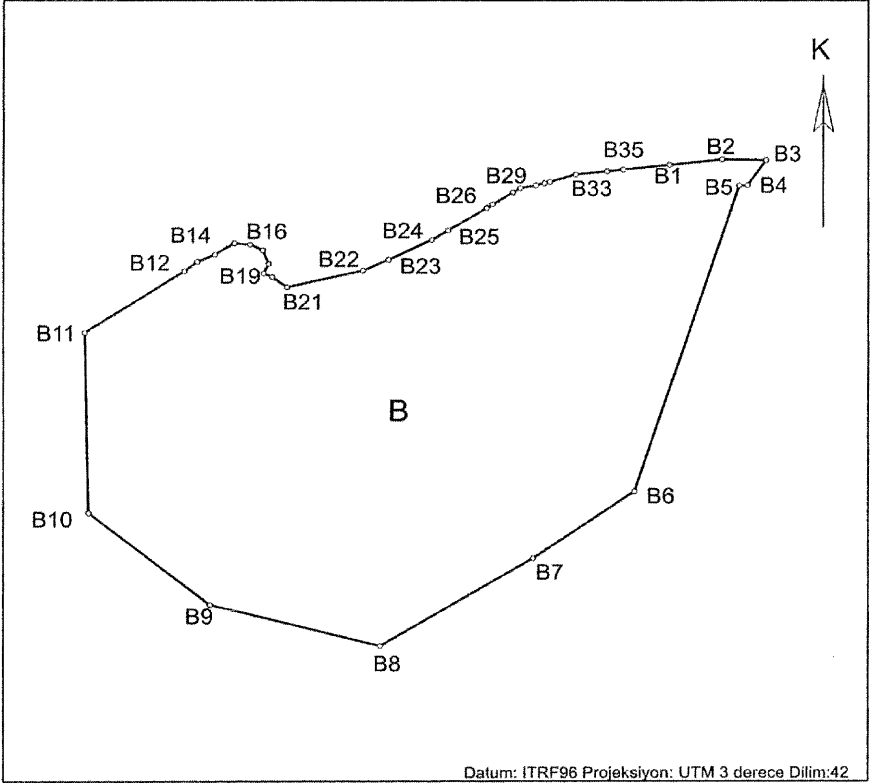

Datum: ITRF96 Projeksiyon: UTM 3 derece Dilim:42

Ada	Parsel	Noktalar	HesapAlan
214	B	B1,B2,B3,B4,B5,B6,B7,B8,B9, B10,B11,B12,B13,B14,B15,B16, B17,B18,B19,B20,B21,B22,B23, B24,B25,B26,B27,B28,B29,B30, B31,B32,B33,B34,B35	258471.30

NoktaNo	Y	X	NoktaNo	Y	X
B1	369489.08	4305615.62	B2	369545.51	4305621.80
B3	369593.12	4305621.04	B4	369573.19	4305592.15
B5	369564.28	4305591.72	B6	369451.68	4305237.51
B7	369341.08	4305160.20	B8	369175.18	4305059.12
B9	368990.21	4305106.53	B10	368857.63	4305213.07
B11	368853.44	4305421.40	B12	368962.33	4305492.41
B13	368976.43	4305503.32	B14	368995.41	4305511.81
B15	369016.17	4305524.78	B16	369033.15	4305523.24
B17	369047.06	4305516.82	B18	369053.48	4305501.05
B19	369047.86	4305489.82	B20	369057.21	4305485.75
B21	369073.66	4305474.03	B22	369155.73	4305493.31
B23	369184.24	4305505.96	B24	369230.76	4305528.80
B25	369248.50	4305539.87	B26	369290.29	4305565.68
B27	369296.80	4305569.95	B28	369318.88	4305583.67
B29	369326.88	4305588.83	B30	369343.82	4305592.01
B31	369353.30	4305594.48	B32	369359.02	4305596.17
B33	369387.24	4305604.45	B34	369421.50	4305608.21
B35	369438.97	4305610.13			

İli : BİNGÖL
İlçesi : SOLHAN
Köy/Mahalle : OYMAPINAR

RÖLEVE KROKİSİ

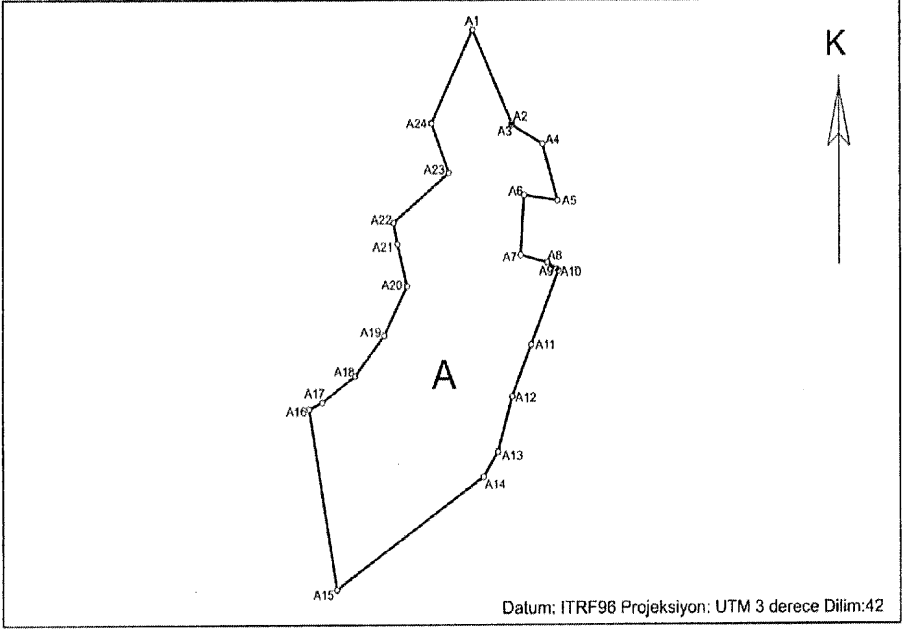

Ada	Parsel	Noktalar	HesapAlan
262	A	A1,A2,A3,A4,A5,A6,A7,A8,A9, A10,A11,A12,A13,A14,A15,A16, A17,A18,A19,A20,A21,A22,A23, A24	60683.10

NoktaNo	Y	X	NoktaNo	Y	X
A1	410214.79	4303727.94	A2	410254.68	4303641.47
A3	410254.64	4303639.64	A4	410285.69	4303622.04
A5	410301.04	4303569.32	A6	410267.14	4303574.35
A7	410263.62	4303519.17	A8	410290.51	4303512.29
A9	410299.69	4303506.39	A10	410301.70	4303504.94
A11	410274.13	4303435.75	A12	410254.82	4303387.80
A13	410240.43	4303336.50	A14	410225.70	4303313.46
A15	410076.17	4303209.28	A16	410047.60	4303376.54
A17	410061.25	4303382.75	A18	410095.22	4303406.88
A19	410125.06	4303444.44	A20	410148.21	4303490.66
A21	410138.64	4303529.42	A22	410134.66	4303548.89
A23	410190.87	4303594.98	A24	410173.29	4303641.07

İli : BİNGÖL

İlçesi : SOLHAN

Köy/Mahalle : OYMAPINAR

RÖLEVE KROKİSİ

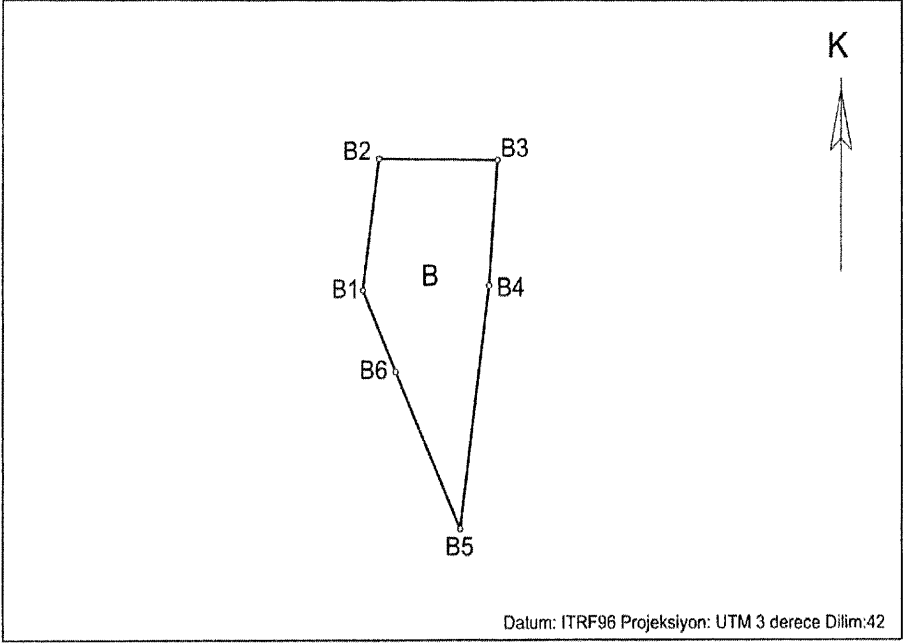

Ada	Parsel	Noktalar	HesapAlan
262	B	B1,B2,B3,B4,B5,B6	4237.70

NoktaNo	Y	X	NoktaNo	Y	X
B1	410217.34	4303746.64	B2	410223.60	4303792.54
B3	410269.98	4303792.11	B4	410266.69	4303748.26
B5	410255.49	4303663.52	B6	410230.11	4303718.27

İli : BURSA
İlçesi : KESTEL
Mahallesi : ÇATALTEPE

RÖLEVE KROKİSİ

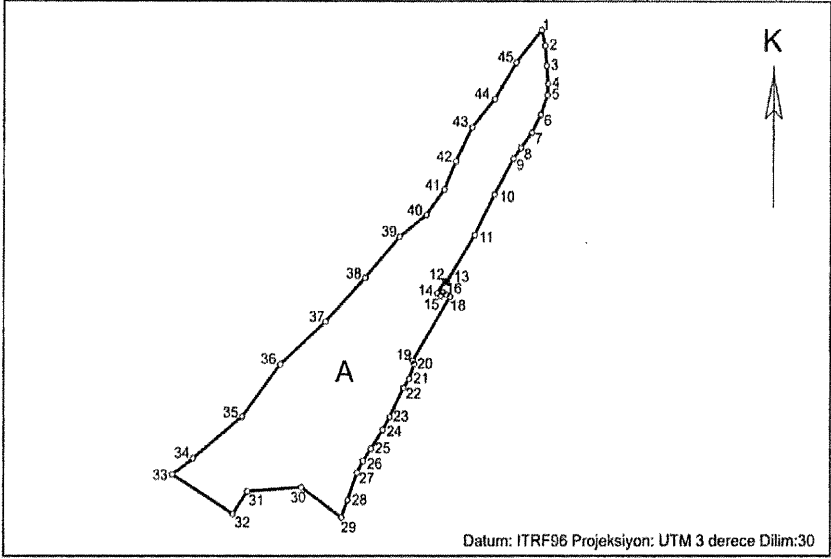

Ada	Parsel	Noktalar	HesapAlan
15		1,2,3,4,5,6,7,8,9,10,11,12,13, 14,15,16,17,18,19,20,21,22,23, 24,25,26,27,28,29,30,31,32,33, 34,35,36,37,38,39,40,41,42,43, 44,45	41280.85

NoktaNo	Y	X	NoktaNo	Y	X
1	439064.53	4452742.69	2	439067.96	4452728.13
3	439069.55	4452709.22	4	439070.96	4452692.49
5	439070.36	4452681.66	6	439063.89	4452663.04
7	439054.91	4452645.88	8	439044.05	4452631.46
9	439036.36	4452621.24	10	439017.67	4452587.50
11	438997.66	4452549.23	12	438970.25	4452504.81
13	438968.99	4452505.74	14	438960.68	4452494.47
15	438964.33	4452491.81	16	438966.43	4452495.21
17	438969.92	4452492.95	18	438973.56	4452491.05
19	438936.42	4452430.22	20	438937.82	4452427.07
21	438932.78	4452413.06	22	438927.30	4452404.51
23	438913.27	4452376.67	24	438906.25	4452364.61
25	438894.41	4452346.86	26	438886.30	4452335.46
27	438880.38	4452324.50	28	438870.52	4452298.41
29	438864.38	4452282.19	30	438824.24	4452310.69
31	438769.87	4452306.88	32	438755.28	4452285.80
33	438694.87	4452322.59	34	438715.34	4452337.82
35	438764.74	4452377.20	36	438802.78	4452426.60
37	438848.17	4452467.32	38	438888.23	4452508.70
39	438922.94	4452547.42	40	438949.64	4452568.11
41	438967.66	4452592.14	42	438979.01	4452618.84
43	438995.03	4452650.89	44	439017.72	4452677.59
45	439039.08	4452712.30			

İli : BURSA
İlçesi : MUDANYA
Mahallesi : SÖĞÜTPINAR

RÖLEVE KROKISI

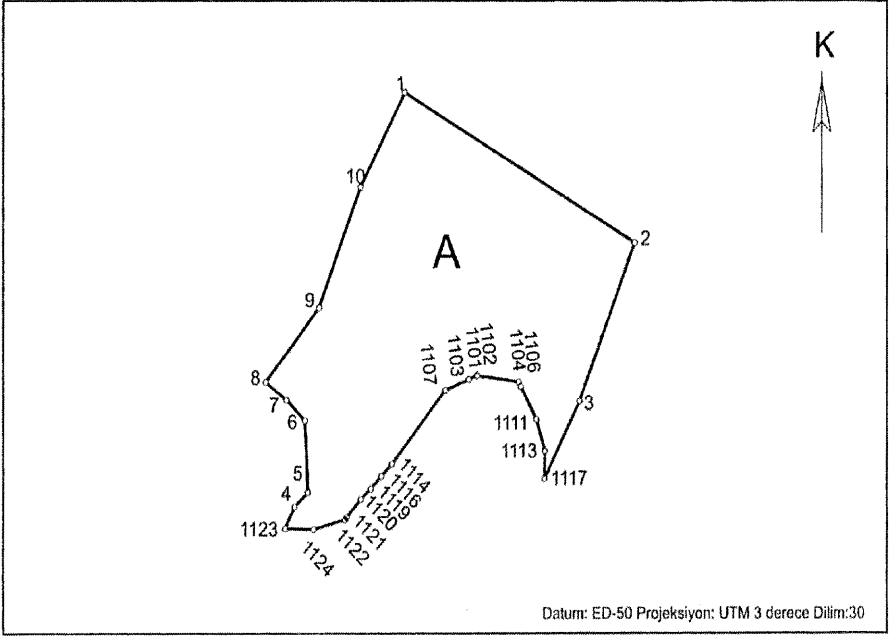

Ada	Parsel	Noktalar	HesapAlan
104	719-A	9,10,1,2,3,1117,1113,1111,1106,1104,1102,1101,1103,1107,1114,1116,1119,1120,1121,1122,1124,1123,4,5,6,7,8	3903.12

NoktaNo	Y	X	NoktaNo	Y	X
1	385278.59	4470235.30	2	385332.44	4470204.37
3	385319.55	4470171.82	4	385252.87	4470150.14
5	385256.04	4470153.12	6	385255.32	4470167.89
7	385250.99	4470172.10	8	385246.18	4470175.76
9	385258.65	4470191.08	10	385268.28	4470215.90
1101	385295.47	4470177.11	1102	385295.49	4470177.10
1103	385293.55	4470176.32	1104	385305.23	4470175.79
1106	385305.75	4470174.84	1107	385288.07	4470174.09
1111	385309.39	4470168.12	1113	385311.41	4470161.58
1114	385275.57	4470158.89	1116	385273.10	4470156.44
1117	385311.33	4470155.89	1119	385270.67	4470153.90
1120	385268.34	4470151.71	1121	385265.05	4470147.89
1122	385264.69	4470147.46	1123	385250.66	4470145.62
1124	385257.30	4470145.48			

İli : ÇORUM
İlçesi : OĞUZLAR
Mahallesi : ÇARŞI

RÖLEVE KROKİSİ

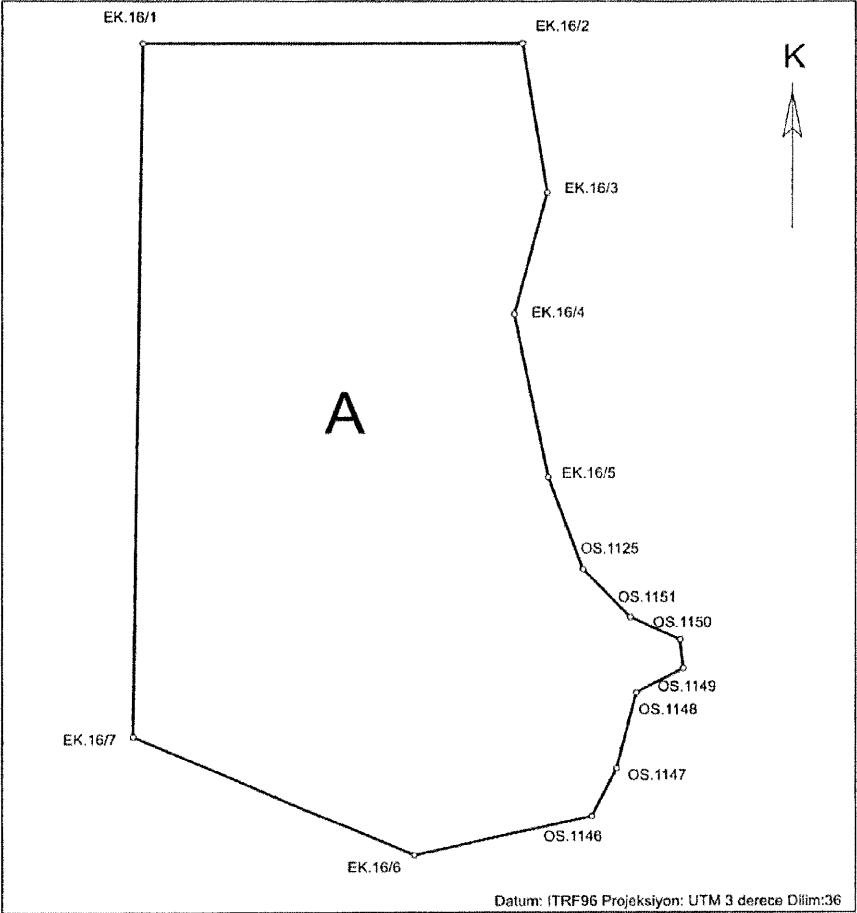

Ada	Parsel	Noktalar	HesapAlan
744	3-A	EK.16/1,EK.16/2,EK.16/3, EK.16/4,EK.16/5,OS.1125, OS.1151,OS.1150,OS.1149, OS.1148,OS.1147,OS.1146, EK.16/6,EK.16/7	73620.87

NoktaNo	Y	X	NoktaNo	Y	X
EK.16/1	391546.38	4512352.27	EK.16/2	391722.68	4512352.27
EK.16/3	391734.11	4512280.44	EK.16/4	391718.88	4512222.22
EK.16/5	391734.66	4512143.86	EK.16/6	391672.89	4511962.10
EK.16/7	391542.13	4512019.16	OS.1125	391750.71	4512099.69
OS.1146	391754.77	4511980.87	OS.1147	391766.29	4512003.99
OS.1148	391775.39	4512040.43	OS.1149	391796.92	4512052.17
OS.1150	391795.50	4512065.94	OS.1151	391772.55	4512076.71

İli : ESKİŞEHİR
İlçesi : ODUNPAZARI
Köyü : AŞAĞILICA

RÖLEVE KROKİSİ

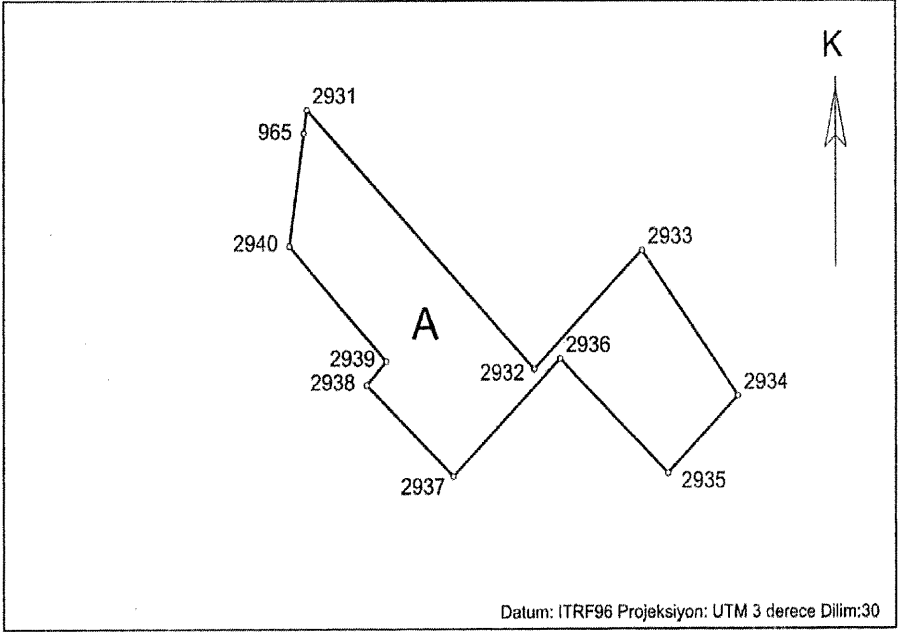

Ada	Parsel	Noktalar	HesapAlan
27051	1-A	2931,2932,2933,2934,2935,2936, 2937,2938,2939,2940,270510965	382.78

NoktaNo	Y	X	NoktaNo	Y	X
2931	538950.61	4381905.55	2932	538970.18	4381885.46
2933	538979.46	4381894.65	2934	538987.74	4381883.38
2935	538981.69	4381877.38	2936	538972.43	4381886.28
2937	538963.21	4381877.16	2938	538955.75	4381884.24
2939	538957.44	4381886.08	2940	538949.07	4381895.01
270510965	538950.34	4381903.72			

İli : GAZİANTEP
İlçesi : ŞEHİTKAMİL
Mahallesi : IŞIKLI

RÖLEVE KROKİSİ

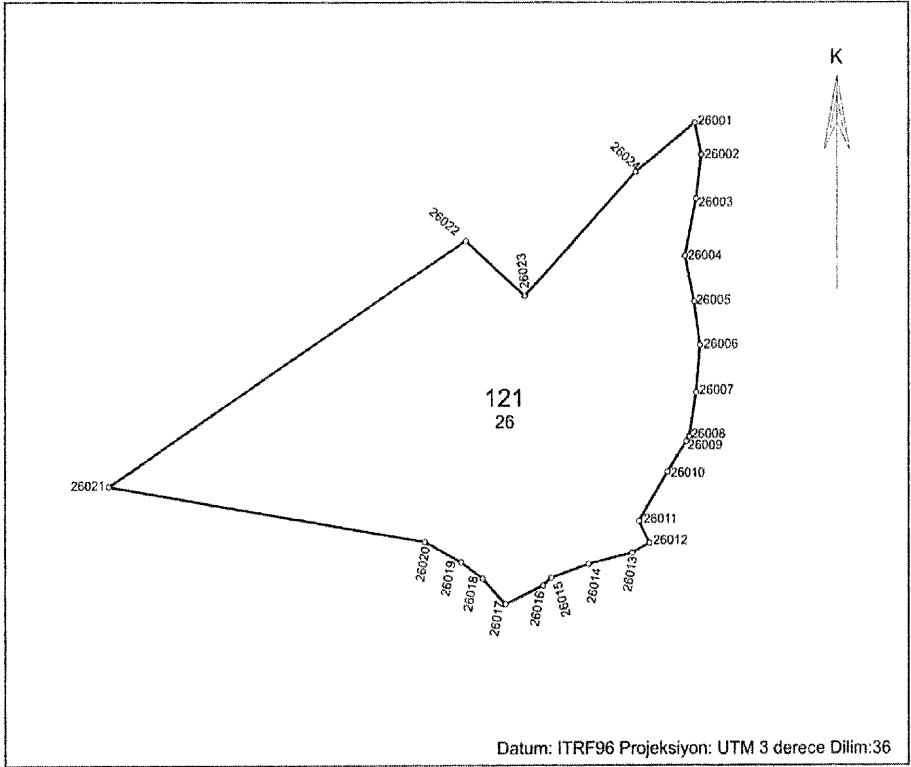

Ada	Parsel	Noktalar	HesapAlan
121	26	26021,26022,26023,26024,26001,26002,26003,26004,26005,26006,26007,26008,26009,26010,26011,26012,26013,26014,26015,26016,26017,26018,26019,26020	20517.75

NoktaNo	Y	X	NoktaNo	Y	X
26001	605290.99	4113950.34	26002	605293.70	4113938.15
26003	605291.50	4113921.03	26004	605286.94	4113898.88
26005	605290.71	4113880.97	26006	605293.07	4113864.01
26007	605291.50	4113845.78	26008	605288.67	4113828.66
26009	605287.48	4113826.81	26010	605279.88	4113814.99
26011	605268.30	4113795.96	26012	605272.56	4113787.40
26013	605265.60	4113783.63	26014	605247.98	4113779.18
26015	605232.94	4113773.78	26016	605229.63	4113770.84
26017	605214.57	4113763.58	26018	605205.51	4113773.44
26019	605196.80	4113779.93	26020	605182.42	4113787.92
26021	605054.16	4113809.43	26022	605198.80	4113904.63
26023	605222.41	4113883.18	26024	605267.06	4113931.41

İli : GAZİANTEP
İlçesi : ŞEHİTKAMİL
Mahallesi : IŞIKLI

RÖLEVE KROKİSİ

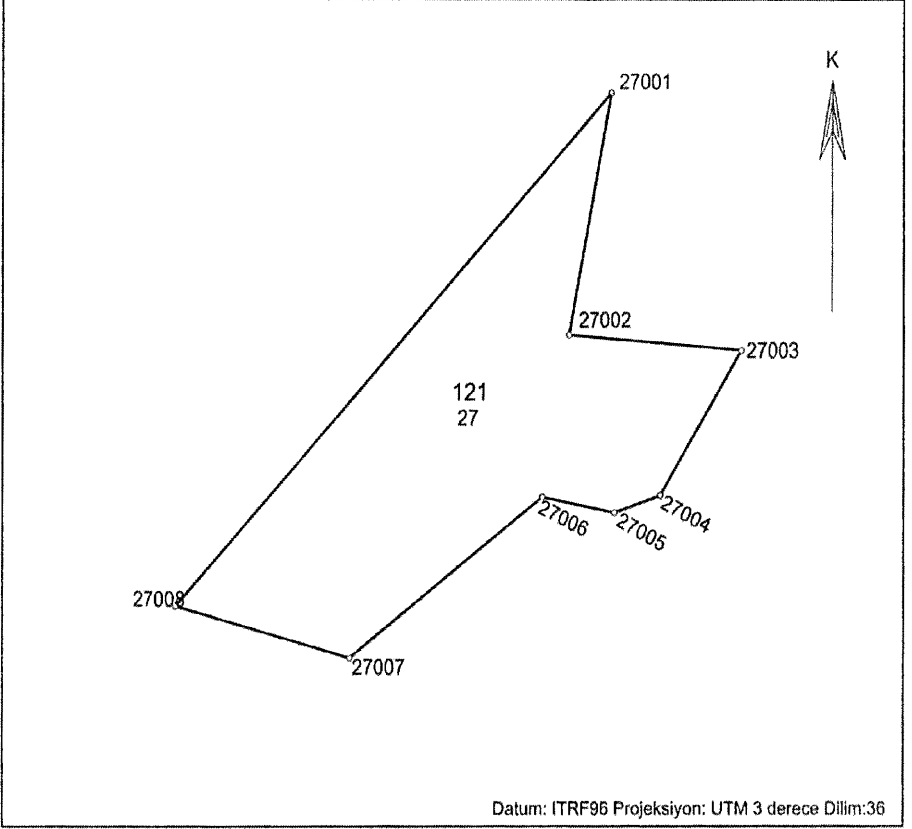

Ada	Parsel	Noktalar	HesapAlan
121	27	27001,27002,27003,27004,27005, 27006,27007,27008	1192.50

NoktaNo	Y	X	NoktaNo	Y	X
27001	605262.58	4113976.47	27002	605257.94	4113953.02
27003	605276.83	4113951.56	27004	605268.02	4113937.52
27005	605262.96	4113935.84	27006	605255.01	4113937.35
27007	605233.91	4113921.78	27008	605214.97	4113926.77

İli : GÜMÜŞHANE
İlçesi : MERKEZ
Köyü : İKİSU

RÖLEVE KROKİSİ

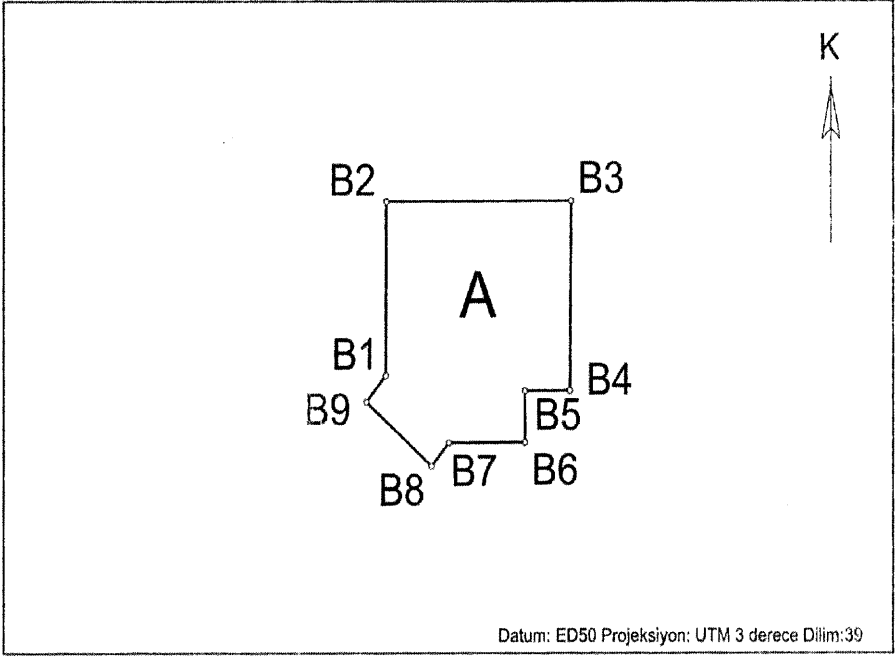

Ada	Parsel	Noktalar	HesapAlan
114	154-A	B1,B2,B3,B4,B5,B6,B7,B8,B9	197.41

NoktaNo	Y	X	NoktaNo	Y	X
B1	532120.00	4488062.47	B2	532120.03	4488073.43
B3	532133.55	4488073.47	B4	532133.46	4488061.54
B5	532130.18	4488061.52	B6	532130.19	4488058.27
B7	532124.60	4488058.24	B8	532123.35	4488056.76
B9	532118.58	4488060.81			

İli : İZMİR
İlçesi : KEMALPAŞA
Mahallesi : ÇAMBELEK

RÖLEVE KROKİSİ

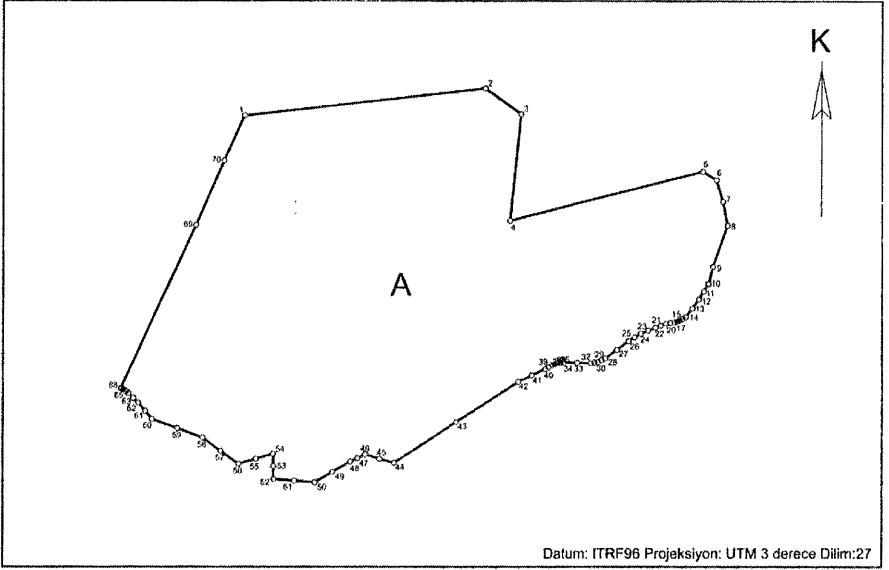

Datum: ITRF96 Projeksiyon: UTM 3 derece Dilim:27

Ada	Parsel	Noktalar	HesapAlan
2401/1-A		3,4,5,6,7,8,9,10,11,12,13,14, 15,16,17,18,19,20,21,22,23,24, 25,26,27,28,29,30,31,32,33,34, 35,36,37,38,39,40,41,42,43,44, 45,46,47,48,49,50,51,52,53,54, 55,56,57,58,59,60,61,62,63,64, 65,66,67,68,69,70,1,2	145913.72

NoktaNo	Y	X	NoktaNo	Y	X
1	544327.33	4258687.37	2	544570.73	4258714.29
3	544607.09	4258688.96	4	544596.00	4258593.50
5	544790.33	4258632.07	6	544804.21	4258623.67
7	544810.96	4258602.38	8	544815.54	4258578.81
9	544500.90	4258538.09	10	544796.53	4258620.96
11	544791.82	4258513.26	12	544786.71	4258505.56
13	544780.10	4258496.90	14	544773.49	4258488.25
15	544770.56	4258486.54	16	544767.63	4258484.84
17	544765.11	4258483.95	18	544762.59	4258483.07
19	544758.29	4258482.45	20	544754.00	4258481.84
21	544748.61	4258479.80	22	544743.23	4258477.75
23	544735.87	4258474.82	24	544728.51	4258471.89
25	544722.50	4258468.13	26	544716.49	4258464.37
27	544704.67	4258455.86	28	544692.86	4258447.36
29	544689.17	4258445.69	30	544685.49	4258444.01
31	544682.02	4258443.34	32	544678.55	4258442.67
33	544664.73	4258442.97	34	544650.90	4258443.26
35	544647.32	4258442.90	36	544643.74	4258442.54
37	544641.33	4258441.63	38	544638.92	4258440.72
39	544635.58	4258438.74	40	544632.24	4258436.77
41	544618.51	4258430.42	42	544604.78	4258424.07
43	544541.96	4258384.08	44	544479.14	4258344.09
45	544464.49	4258348.25	46	544449.85	4258352.42
47	544442.33	4258348.94	48	544434.81	4258345.47
49	544416.75	4258335.21	50	544398.70	4258324.95
51	544377.87	4258326.59	52	544357.03	4258328.22
53	544356.84	4258340.68	54	544356.66	4258353.14
55	544339.16	4258348.09	56	544321.66	4258343.04
57	544303.47	4258355.98	58	544285.29	4258368.92
59	544260.00	4258378.01	60	544234.71	4258387.09
61	544227.68	4258395.15	62	544220.64	4258403.20
63	544215.66	4258407.96	64	544210.67	4258412.71
65	544208.09	4258414.60	66	544205.50	4258416.49
67	544203.82	4258417.30	68	544203.02	4258417.69
69	544278.62	4258579.22	70	544306.86	4258642.94

İl : KARABÜK
İlçesi : YENİCE
Köyü : BAĞBAŞI

RÖLEVE KROKİSİ

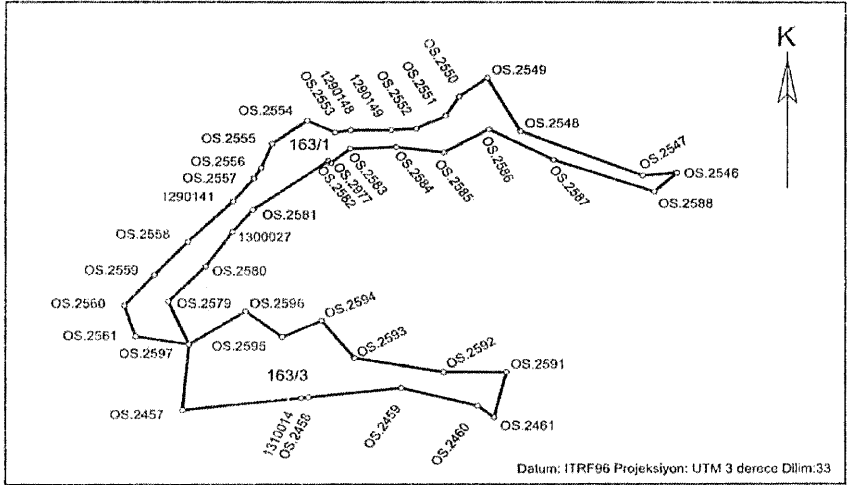

Ada	Parsel	Noktalar	HesapAlan
163	1	OS.2582,OS.2581,1300027, OS.2580,OS.2579,OS.2597, OS.2561,OS.2560,OS.2559, OS.2558,1290141,OS.2557, OS.2556,OS.2555,OS.2554, OS.2553,1290148,1290149, OS.2552,OS.2551,OS.2550, OS.2549,OS.2548,OS.2547, OS.2546,OS.2588,OS.2587, OS.2586,OS.2585,OS.2584, OS.2583,OS.2977	295.48
163	3	OS.2597,OS.2596,OS.2595, OS.2594,OS.2593,OS.2592, OS.2591,OS.2461,OS.2460, OS.2459,OS.2458,1310014, OS.2457	283.65

NoktaNo	Y	X	NoktaNo	Y	X
1290141	438314.61	4563435.14	1290148	438329.34	4563444.97
1290149	438334.45	4563445.00	1300027	438314.53	4563430.94
1310014	438323.12	4563408.00	OS.2457	438308.23	4563406.35
OS.2458	438324.08	4563408.09	OS.2459	438335.77	4563409.38
OS.2460	438345.31	4563406.91	OS.2461	438347.36	4563405.32
OS.2546	438370.16	4563439.05	OS.2547	438365.87	4563438.70
OS.2548	438350.62	4563444.81	OS.2549	438346.49	4563452.21
OS.2550	438342.96	4563449.58	OS.2551	438341.27	4563446.94
OS.2552	438337.59	4563445.18	OS.2553	438327.38	4563444.67
OS.2554	438323.87	4563446.28	OS.2555	438319.49	4563443.09
OS.2556	438318.10	4563439.75	OS.2557	438317.19	4563438.30
OS.2558	438308.89	4563429.56	OS.2559	438304.69	4563425.01
OS.2560	438300.88	4563420.79	OS.2561	438302.29	4563416.53
OS.2579	438306.44	4563421.36	OS.2580	438311.14	4563426.17
OS.2581	438317.09	4563433.95	OS.2582	438326.57	4563440.75
OS.2583	438329.27	4563442.44	OS.2584	438335.11	4563442.65
OS.2585	438341.05	4563441.94	OS.2586	438346.70	4563445.09
OS.2587	438354.77	4563440.86	OS.2588	438367.32	4563436.48
OS.2591	438348.91	4563411.56	OS.2592	438341.04	4563411.58
OS.2593	438329.83	4563413.53	OS.2594	438325.71	4563418.70
OS.2595	438320.78	4563416.43	OS.2596	438316.18	4563419.99
OS.2597	438309.06	4563415.42	OS.2977	438326.87	4563440.44

İli : KASTAMONU
İlçesi : MERKEZ
Köyü : KAYALI

RÖLEVE KROKİSİ

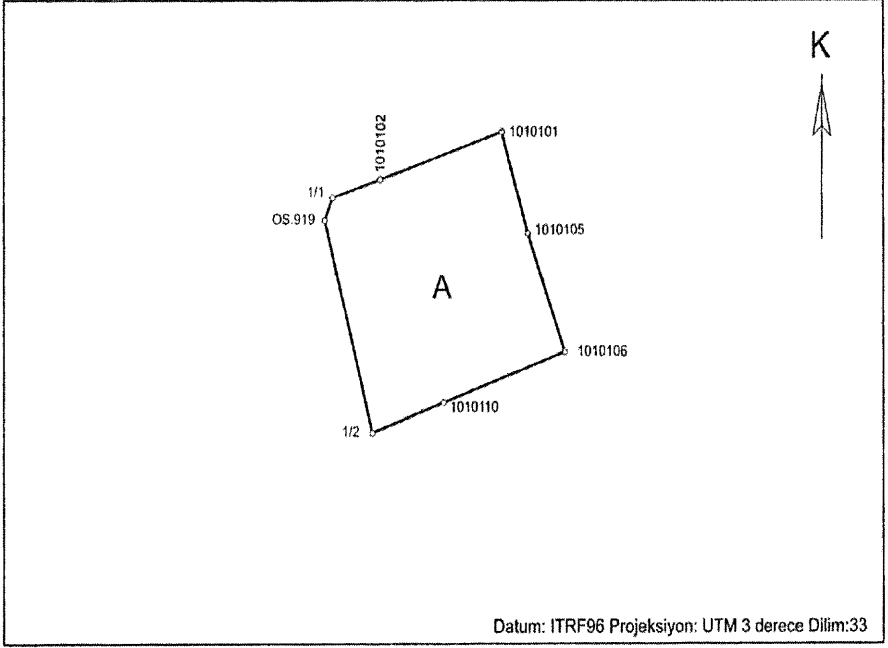

Ada	Parsel	Noktalar	HesapAlan
101	1-A	1010105,1010106,1010110,1/2, OS.919,1/1,1010102,1010101	215.85

NoktaNo	Y	X	NoktaNo	Y	X
1/1	573900.34	4590849.23	1/2	573903.26	4590834.21
1010101	573912.80	4590853.42	1010102	573903.85	4590850.39
1010105	573914.71	4590846.93	1010106	573917.45	4590839.35
1010110	573908.50	4590836.13	OS.919	573899.78	4590847.79

İli : KÜTAHYA
İlçesi : EMET
Köyü : YENİCE

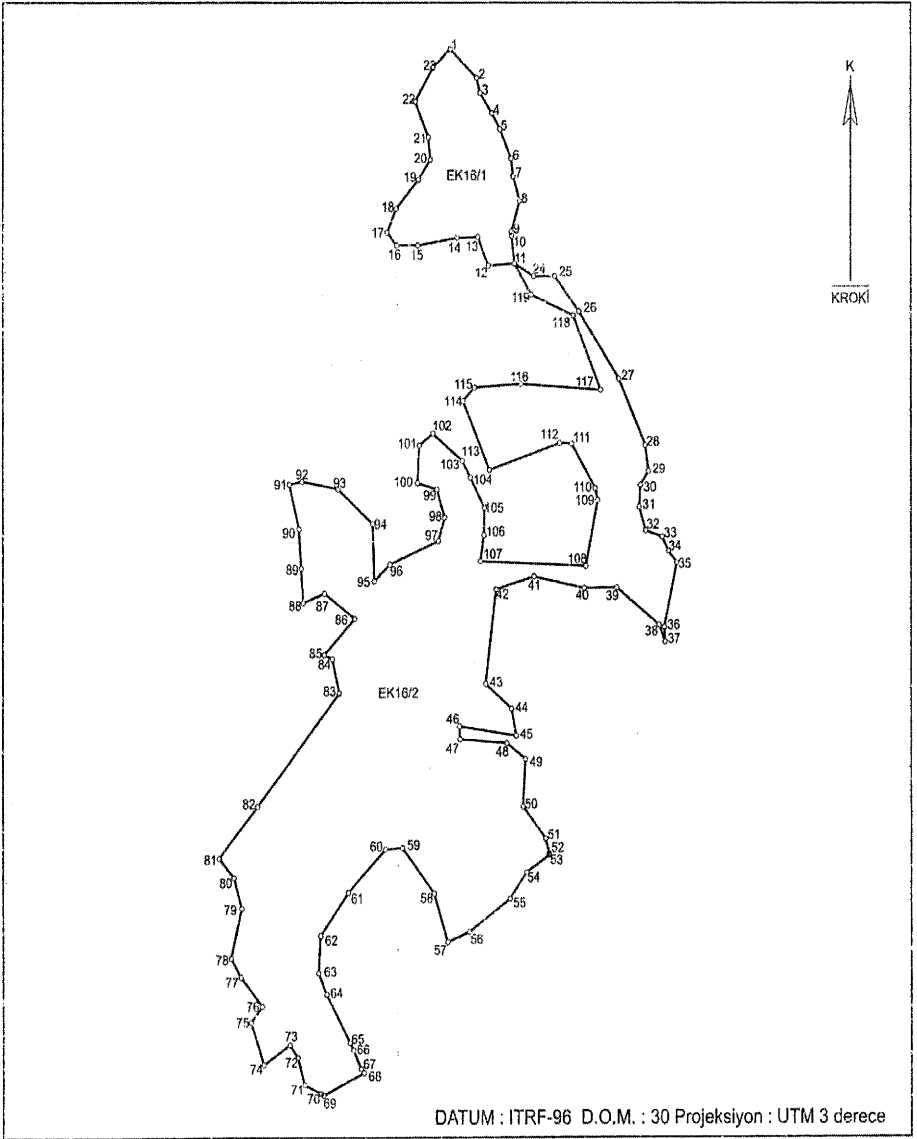

DATUM : ITRF-96 D.O.M. : 30 Projeksiyon : UTM 3 derece

İli : KÜTAHYA
İlçesi : EMET
Köyü : YENİCE

KOORDİNE ÖZETLİ ALAN HESAP CETVELİ

DATUM : ITRF-96 D.O.M. : 30 Projeksiyon : UTM 3 derece

NoktaNo	Y	X	NoktaNo	Y	X
1	434223.54	4354655.74	2	434261.51	4354620.23
3	434266.81	4354601.88	4	434283.93	4354577.42
5	434295.79	4354557.60	6	434312.06	4354521.37
7	434314.91	4354499.77	8	434324.61	4354468.97
9	434312.47	4354431.08	10	434313.03	4354426.11
11	434316.87	4354391.92	12	434278.72	4354389.38
13	434263.29	4354424.53	14	434233.58	4354423.59
15	434176.74	4354414.15	16	434145.93	4354414.16
17	434131.99	4354430.26	18	434145.17	4354459.46
19	434177.31	4354495.37	20	434194.72	4354519.69
21	434191.87	4354547.71	22	434172.83	4354591.52
23	434198.43	4354632.47	24	434345.19	4354376.09
25	434375.76	4354376.24	26	434410.68	4354332.77
27	434468.39	4354250.50	28	434506.31	4354168.63
29	434510.78	4354136.37	30	434499.37	4354119.24
31	434497.68	4354092.10	32	434506.72	4354063.17
33	434530.32	4354055.72	34	434539.42	4354038.33
35	434551.50	4354023.90	36	434533.37	4353944.89
37	434534.56	4353927.08	38	434525.93	4353947.30
39	434465.30	4353993.55	40	434418.12	4353992.93
41	434345.31	4354007.45	42	434289.83	4353991.64
43	434274.64	4353875.90	44	434312.51	4353844.94
45	434319.36	4353811.59	46	434236.66	4353823.53
47	434237.49	4353807.55	48	434305.56	4353802.62
49	434332.78	4353783.06	50	434329.11	4353724.16
51	434362.03	4353684.05	52	434367.26	4353665.51
53	434367.56	4353664.01	54	434334.48	4353642.67
55	434310.14	4353610.16	56	434250.57	4353569.18
57	434219.47	4353557.00	58	434199.82	4353616.70
59	434153.91	4353672.86	60	434128.80	4353671.16
61	434075.10	4353617.97	62	434034.46	4353665.02
63	434031.69	4353518.88	64	434043.39	4353492.66
65	434077.27	4353432.77	66	434082.51	4353423.50
67	434093.47	4353400.02	68	434097.72	4353395.17
69	434038.62	4353367.27	70	434035.25	4353369.23
71	434011.38	4353380.19	72	434001.54	4353414.11
73	433989.75	4353430.11	74	433952.45	4353405.35
75	433934.00	4353458.40	76	433950.35	4353477.98
77	433919.68	4353514.17	78	433905.40	4353537.55
79	433920.76	4353598.99	80	433909.87	4353636.46
81	433887.94	4353660.51	82	433943.64	4353724.31
83	434061.99	4353864.67	84	434051.87	4353906.46
85	434040.15	4353911.64	86	434084.70	4353955.68
87	434040.45	4353986.69	88	434009.84	4353975.14
89	434006.80	4354017.60	90	434003.81	4354065.54
91	433989.50	4354120.55	92	434008.09	4354124.16
93	434060.31	4354114.82	94	434110.93	4354071.71
95	434112.97	4354002.17	96	434135.66	4354022.35
97	434206.31	4354050.83	98	434215.46	4354079.28
99	434204.13	4354114.18	100	434176.00	4354121.94
101	434178.63	4354168.63	102	434198.15	4354183.03
103	434240.85	4354149.72	104	434252.38	4354128.75
105	434273.04	4354091.18	106	434272.20	4354058.03
107	434266.94	4354025.81	108	434420.62	4354020.08
109	434437.84	4354100.84	110	434434.18	4354115.43
111	434400.26	4354170.73	112	434383.10	4354171.30
113	434280.23	4354138.24	114	434241.56	4354223.68
115	434258.30	4354239.65	116	434326.16	4354244.09
117	434441.84	4354236.62	118	434402.67	4354327.78
119	434341.42	4354353.51			

İli : KÜTAHYA
İlçesi : EMET
Köyü : YENİCE

KOORDİNE ÖZETLİ ALAN HESAP CETVELİ

DATUM : ITRF-96 D.O.M. : 30 Projeksiyon : UTM 3 derece

Ada	Parsel	Noktalar	HesapAlan
239	EK16/1	19,20,21,22,23,1,2,3,4,5,6,7, 8,9,10,11,12,13,14,15,16,17,18	28848.87
239	EK16/2	29,30,31,32,33,34,35,36,37,38, 39,40,41,42,43,44,45,46,47,48, 49,50,51,52,53,54,55,56,57,58, 59,60,61,62,63,64,65,66,67,68, 69,70,71,72,73,74,75,76,77,78, 79,80,81,82,83,84,85,86,87,88, 89,90,91,92,93,94,95,96,97,98, 99,100,101,102,103,104,105, 106,107,108,109,110,111,112, 113,114,115,116,117,118,119, 11,24,25,26,27,28	219440.20

RÖLEVE KROKİSİ

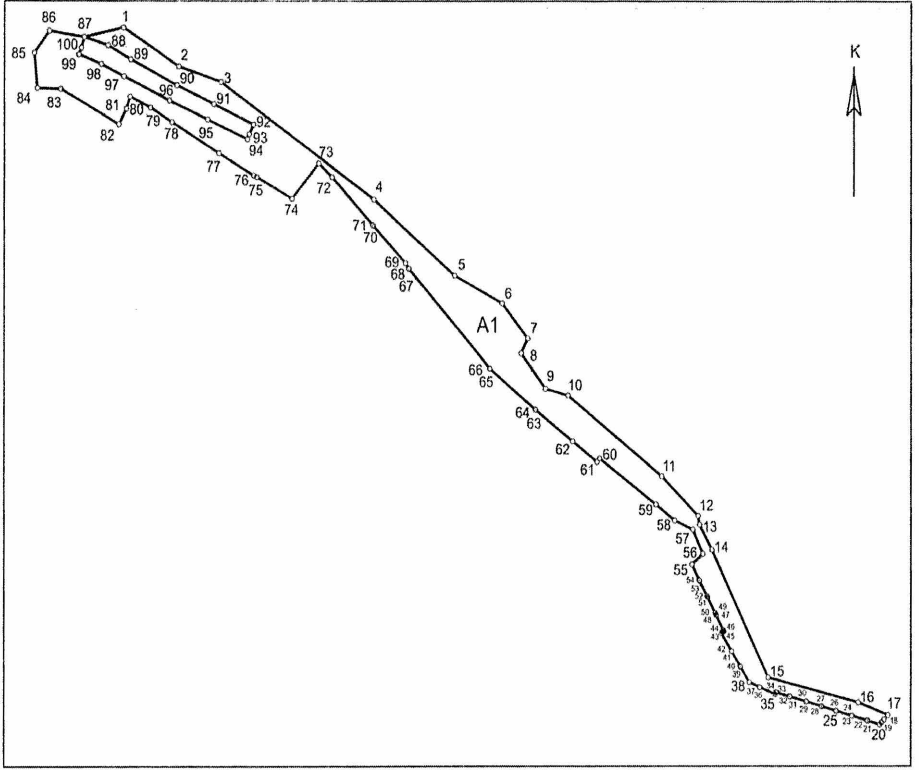

ALAN ÖZET ÇİZELGESİ

Ada	Parsel	Noktalar	HesapAlan
(123/516)	EK16_ALAN1	84,85,86,87,1,2,3,4,5,6,7,8,9, 10,11,12,13,14,15,16,17,18,19, 20,21,22,23,24,25,26,27,28,29, 30,31,32,33,34,35,36,37,38,39, 40,41,42,43,44,45,46,47,48,49, 50,51,52,53,54,55,56,57,58,59, 60,61,62,63,64,65,66,67,68,69, 70,71,72,73,74,75,76,77,78,79, 80,81,82,83,100,99,98,97,96, 95,94,93,92,91,90,89,88	4209.93

KOORDİNE ÖZET ÇİZELGESİ

NoktaNo	Y	X	NoktaNo	Y	X
1	504710.83	4384756.17	2	504731.81	4384743.54
3	504747.88	4384738.50	4	504805.75	4384700.21
5	504836.03	4384675.26	6	504854.00	4384666.13
7	504863.57	4384654.67	8	504861.10	4384649.89
9	504870.20	4384638.33	10	504878.69	4384636.14
11	504913.97	4384609.69	12	504927.69	4384596.75
13	504928.26	4384593.91	14	504932.90	4384585.67
15	504954.35	4384544.03	16	504988.25	4384535.80
17	504999.45	4384531.69	18	504997.99	4384530.29
19	504996.98	4384529.31	20	504996.31	4384528.66
21	504991.76	4384529.90	22	504991.53	4384529.96
23	504985.92	4384531.42	24	504985.86	4384531.43
25	504980.06	4384533.00	26	504979.88	4384533.05
27	504974.59	4384534.48	28	504974.29	4384534.56
29	504968.76	4384536.06	30	504968.66	4384536.09
31	504962.64	4384537.74	32	504962.57	4384537.76
33	504957.38	4384539.11	34	504957.35	4384539.05
35	504957.05	4384538.51	36	504951.22	4384540.78
37	504951.12	4384540.82	38	504947.18	4384542.47
39	504943.83	4384547.41	40	504943.69	4384547.63
41	504940.48	4384552.45	42	504940.46	4384552.49
43	504936.51	4384558.46	44	504936.99	4384558.76
45	504937.49	4384559.02	46	504937.25	4384559.46
47	504934.54	4384564.32	48	504934.47	4384564.45
49	504934.21	4384564.90	50	504934.14	4384565.02
51	504931.28	4384570.19	52	504931.05	4384570.60
53	504928.22	4384575.56	54	504928.09	4384575.81
55	504925.37	4384580.91	56	504929.55	4384584.32
57	504925.70	4384592.30	58	504918.79	4384595.28
59	504911.71	4384600.57	60	504890.59	4384615.58
61	504889.66	4384614.39	62	504880.43	4384621.18
63	504866.50	4384631.43	64	504866.37	4384631.53
65	504849.30	4384644.94	66	504849.24	4384644.98
67	504818.99	4384677.52	68	504818.88	4384677.68
69	504817.72	4384679.37	70	504805.43	4384691.76
71	504805.29	4384691.90	72	504789.87	4384707.46
73	504784.76	4384712.06	74	504774.66	4384700.44
75	504761.42	4384707.51	76	504760.27	4384708.06
77	504747.03	4384715.31	78	504729.32	4384725.47
79	504721.09	4384730.14	80	504713.28	4384733.73
81	504711.91	4384729.82	82	504709.19	4384724.72
83	504687.25	4384736.24	84	504678.46	4384736.45
85	504677.31	4384747.93	86	504682.98	4384755.10
87	504696.05	4384753.06	88	504705.06	4384750.38
89	504713.54	4384745.81	90	504731.18	4384737.42
91	504745.10	4384731.31	92	504760.21	4384724.68
93	504758.49	4384721.54	94	504757.81	4384719.94
95	504742.79	4384726.30	96	504728.40	4384732.41
97	504710.97	4384740.34	98	504702.55	4384744.29
99	504694.06	4384747.42	100	504694.99	4384749.58

RÖLEVE KROKİSİ

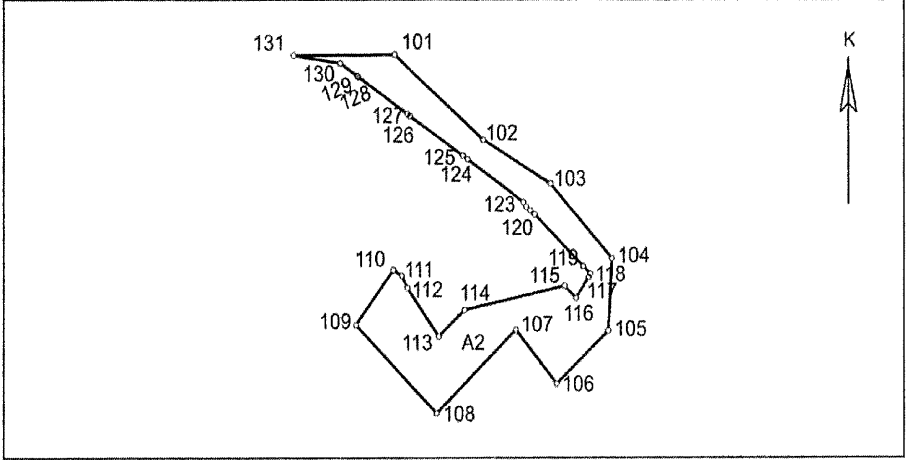

Ada	Parsel	Noktalar	HesapAlan
(123/516)	EK16_ALAN2	131,101,102,103,104,105,106, 107,108,109,110,111,112,113, 114,115,116,117,118,119,120, 121,122,123,124,125,126,127, 128,129,130	499.54

NoktaNo	Y	X	NoktaNo	Y	X
101	505090.45	4384589.21	102	505103.18	4384578.44
103	505112.92	4384572.85	104	505121.83	4384563.38
105	505121.31	4384554.15	106	505113.82	4384547.45
107	505107.90	4384554.31	108	505096.48	4384543.71
109	505084.85	4384554.92	110	505090.25	4384561.93
111	505091.47	4384561.19	112	505092.33	4384559.62
113	505096.78	4384553.44	114	505100.47	4384556.82
115	505114.97	4384559.88	116	505116.62	4384558.35
117	505118.46	4384560.98	118	505118.75	4384561.38
119	505117.67	4384562.38	120	505110.62	4384568.97
121	505110.03	4384569.44	122	505109.43	4384569.93
123	505109.02	4384570.51	124	505100.92	4384575.97
125	505100.22	4384576.44	126	505092.66	4384581.48
127	505092.31	4384581.72	128	505085.18	4384586.47
129	505085.06	4384586.55	130	505082.54	4384588.13
131	505075.79	4384589.11			

RÖLEVE KROKİSİ

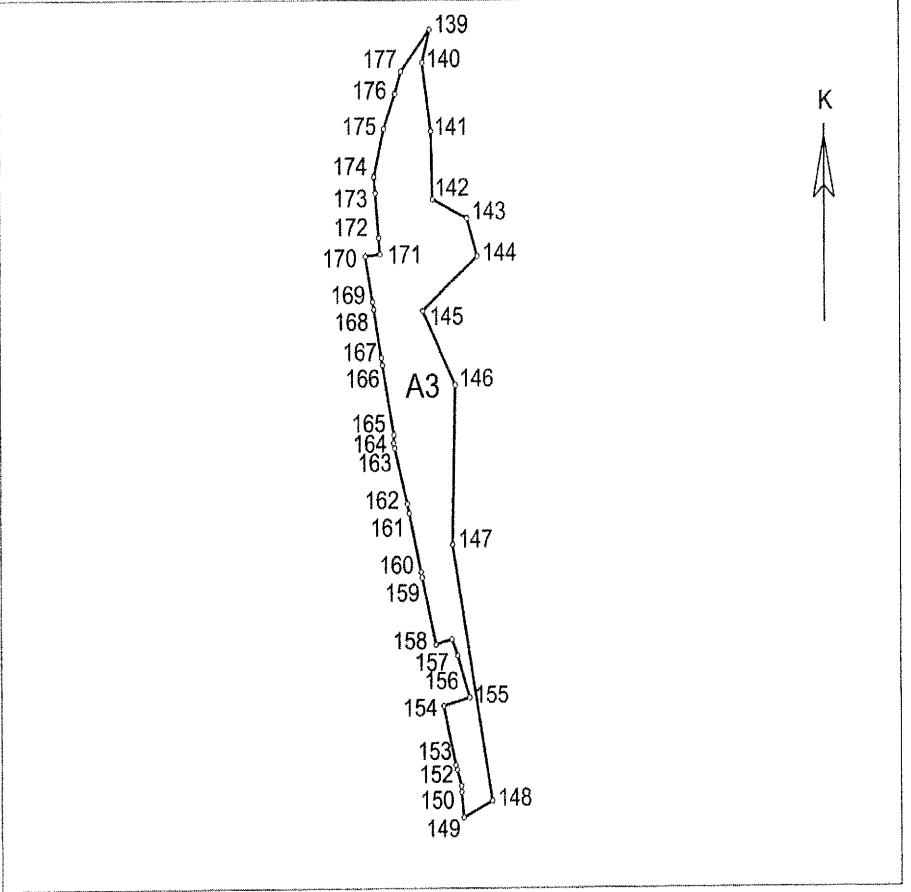

BÖLGE MÜDÜRLÜĞÜ:KÜTAHYA
İŞLETME MÜDÜRLÜĞÜ:KÜTAHYA
İŞLETME SEFLİĞİ:PORSUK
DATUM:İTRF96

İLİ : KÜTAHYA
İLÇESİ : MERKEZ
KÖY: İŞIKKARA
DİLİM:30

KOORDİNE ÖZETLİ ALAN HESABI ÇİZELGESİ

Ada	Parsel	Noktalar	HesapAlan
(123/516)	EK16_ALAN3	139,140,141,142,143,144,145, 146,147,148,149,150,151,152, 153,154,155,156,157,158,159, 160,161,162,163,164,165,166, 167,168,169,170,171,172,173, 174,175,176,177	542.32

NoktaNo	Y	X	NoktaNo	Y	X
139	505055.97	4384563.65	140	505054.97	4384559.89
141	505056.09	4384552.21	142	505056.28	4384544.52
143	505060.93	4384542.42	144	505062.31	4384538.16
145	505054.92	4384532.07	146	505059.30	4384523.70
147	505058.86	4384505.79	148	505064.09	4384476.92
149	505060.23	4384475.06	150	505059.95	4384477.92
151	505059.93	4384478.59	152	505059.35	4384480.41
153	505059.18	4384480.96	154	505057.59	4384487.59
155	505061.09	4384488.55	156	505059.49	4384493.33
157	505058.71	4384495.16	158	505056.55	4384494.57
159	505054.74	4384502.10	160	505054.59	4384502.72
161	505053.04	4384509.32	162	505052.79	4384510.40
163	505051.12	4384516.64	164	505050.96	4384517.26
165	505051.03	4384518.13	166	505049.52	4384525.96
167	505049.36	4384526.80	168	505048.37	4384532.23
169	505048.21	4384533.09	170	505047.24	4384538.21
171	505049.24	4384538.43	172	505049.07	4384540.26
173	505048.61	4384545.26	174	505048.44	4384547.05
175	505049.79	4384552.50	176	505051.31	4384556.40
177	505052.14	4384558.94			

BÖLGE MÜDÜRLÜĞÜ:KÜTAHYA
İŞLETME MÜDÜRLÜĞÜ:KÜTAHYA
İŞLETME SEFLİĞİ:PORSUK
DATUM:ITRF96

İLİ : KÜTAHYA
İLÇESİ : MERKEZ
KÖY: İŞIKKARA
DİLİM:30

RÖLEVE KROKİSİ

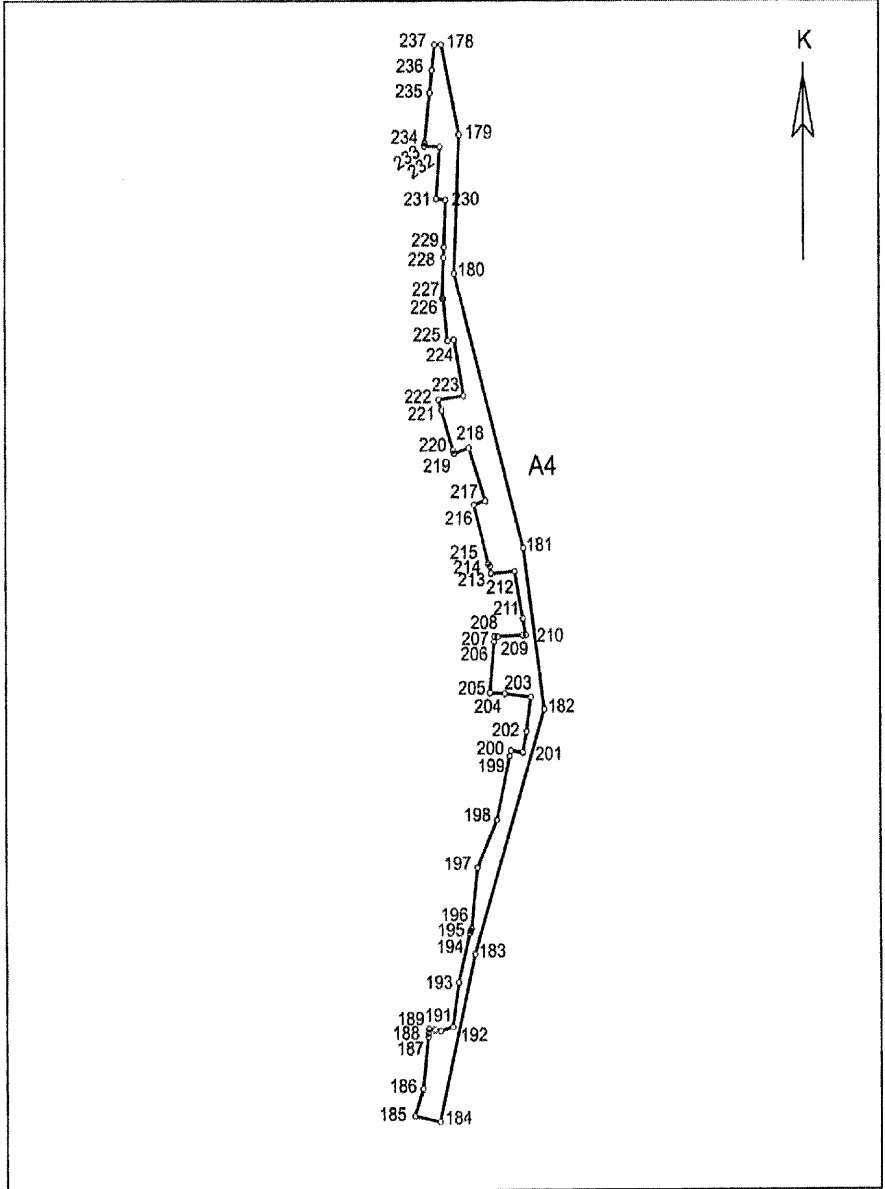

KOORDİNE ÖZETLİ ALAN HESABI ÇİZELGESİ

Ada	Parsel	Noktalar	HesapAlan
(123/516)	EK16_ALAN4	178,179,180,181,182,183,184, 185,186,187,188,189,190,191, 192,193,194,195,196,197,198, 199,200,201,202,203,204,205, 206,207,208,209,210,211,212, 213,214,215,216,217,218,219, 220,221,222,223,224,225,226, 227,228,229,230,231,232,233, 234,235,236,237	595.30

NoktaNo	Y	X	NoktaNo	Y	X
178	505061.27	4384461.52	179	505064.24	4384448.06
180	505063.37	4384427.27	181	505074.95	4384386.31
182	505078.41	4384362.21	183	505066.60	4384325.50
184	505060.61	4384300.38	185	505056.32	4384301.27
186	505057.75	4384305.35	187	505058.62	4384313.17
188	505058.68	4384313.76	189	505058.75	4384314.35
190	505059.80	4384314.20	191	505060.79	4384314.07
192	505062.83	4384314.63	193	505063.81	4384321.31
194	505065.70	4384328.62	195	505065.86	4384328.97
196	505066.02	4384329.31	197	505067.05	4384338.49
198	505070.35	4384345.64	199	505072.57	4384355.23
200	505072.77	4384356.07	201	505074.80	4384355.77
202	505075.40	4384358.87	203	505076.15	4384364.03
204	505071.76	4384364.54	205	505069.25	4384364.66
206	505069.95	4384372.35	207	505070.02	4384373.08
208	505070.55	4384373.11	209	505074.81	4384373.26
210	505075.33	4384373.28	211	505074.85	4384375.76
212	505073.48	4384382.80	213	505069.48	4384382.49
214	505069.36	4384383.62	215	505069.03	4384383.96
216	505066.61	4384392.82	217	505068.56	4384393.39
218	505065.76	4384401.28	219	505063.30	4384400.45
220	505063.11	4384400.91	221	505061.18	4384406.84
222	505060.66	4384408.44	223	505064.91	4384409.04
224	505063.34	4384417.43	225	505062.23	4384417.27
226	505061.53	4384423.51	227	505061.35	4384423.52
228	505061.61	4384429.68	229	505061.67	4384431.26
230	505061.97	4384438.34	231	505060.36	4384438.51
232	505061.02	4384446.27	233	505058.34	4384446.36
234	505058.44	4384446.78	235	505059.30	4384454.29
236	505059.67	4384457.64	237	505060.12	4384461.49

İli
İlçesi
Köyü

KÜTAHYA
MERKEZ
SOĞUKÇEŞME

RÖLEVE KROKİSİ

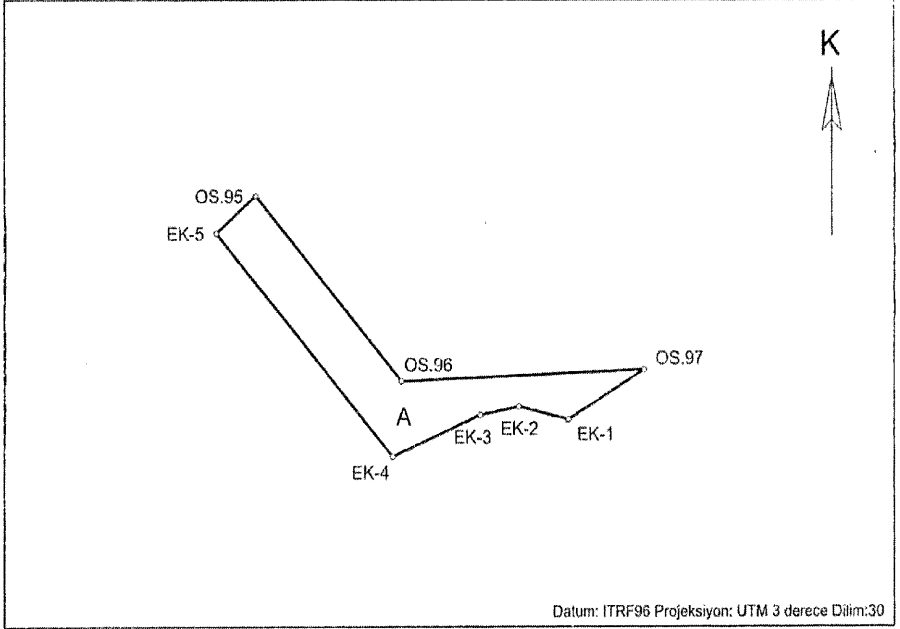

Ada	Parsel	Noktalar	HesapAlan
154	827-A	EK-1,EK-2,EK-3,EK-4,EK-5, OS.95,OS.96,OS.97	566.60

NoktaNo	Y	X	NoktaNo	Y	X
EK-1	504749.39	4383923.47	EK-2	504741.23	4383925.38
EK-3	504734.94	4383924.14	EK-4	504720.66	4383918.01
EK-5	504691.89	4383950.90	OS.95	504698.33	4383956.36
OS.96	504722.07	4383929.14	OS.97	504761.95	4383930.76

İli : MERSİN
İlçesi : MEZİTLİ
Mahallesi : DAVULTEPE

RÖLEVE KROKİSİ

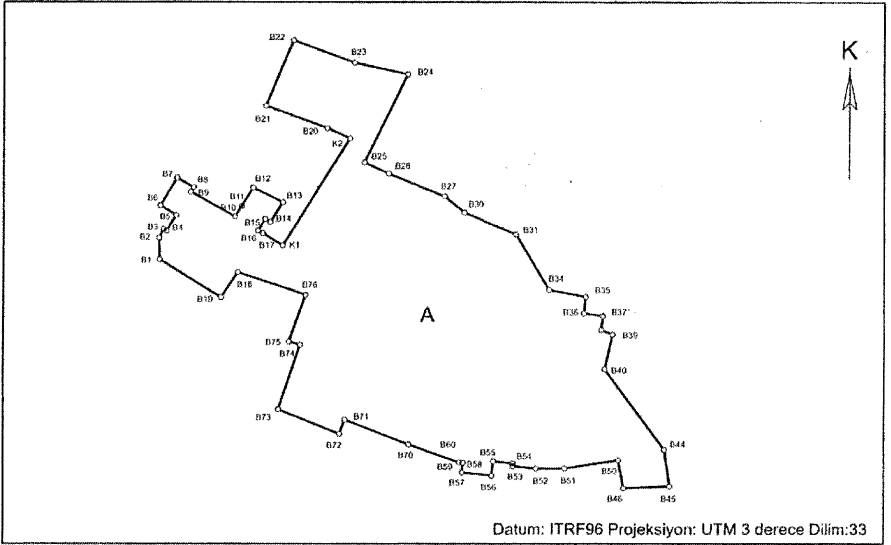

Datum: ITRF96 Projeksiyon: UTM 3 derece Dilim:33

NoktaNo	Y	X	NoktaNo	Y	X
B1	631891.55	4066943.77	B2	631891.45	4066948.10
B3	631892.30	4066949.88	B4	631892.89	4066949.52
B5	631894.74	4066952.60	B6	631891.72	4066954.56
B7	631894.90	4066960.05	B8	631898.12	4066958.21
B9	631897.58	4066957.31	B10	631906.06	4066952.34
B12	631909.60	4066958.17	B13	631915.32	4066955.20
B14	631912.86	4066951.26	B15	631911.85	4066951.85
B16	631910.50	4066949.53	B17	631911.44	4066948.99
B18	631906.63	4066941.27	B19	631903.38	4066936.22
B20	631923.87	4066970.02	B21	631912.01	4066974.47
B22	631917.26	4066987.44	B23	631929.12	4066982.99
B24	631939.57	4066980.67	B25	631931.12	4066963.18
B26	631935.90	4066960.95	B27	631946.74	4066956.44
B30	631950.48	4066953.22	B31	631960.51	4066948.85
B34	631967.01	4066937.76	B35	631974.08	4066936.38
B36	631973.81	4066933.16	B37	631977.49	4066932.62
B38	631977.17	4066929.81	B39	631979.39	4066928.92
B40	631977.86	4066922.07	B44	631989.41	4066906.10
B45	631990.49	4066898.82	B46	631981.58	4066898.47
B50	631980.56	4066904.03	B51	631970.10	4066902.37
B52	631964.54	4066902.33	B53	631980.00	4066902.82
B54	631960.06	4066903.37	B55	631956.25	4066903.79
B56	631955.94	4066900.93	B57	631950.16	4066901.56
B58	631950.37	4066903.47	B59	631949.61	4066903.56
B70	631939.86	4066907.10	B71	631927.33	4066911.98
B72	631926.35	4066909.16	B73	631914.48	4066914.01
B74	631918.66	4066926.85	B75	631916.51	4066927.48
B76	631919.71	4066936.72	K1	631915.28	4066946.55
K2	631928.24	4066967.96			

Ada	Parsel	Noktalar	HesapAlan
584	13-A	B31,B34,B35,B36,B37,B38,B39, B40,B44,B45,B46,B50,B51,B52, B53,B54,B55,B56,B57,B58,B59, B70,B71,B72,B73,B74,B75,B76, B18,B19,B1,B2,B3,B4,B5,B6,B7, B8,B9,B10,B12,B13,B14,B15,B16, B17,K1,K2,B20,B21,B22,B23,B24, B25,B26,B27,B30	3687,12

İli : MERSİN
İlçesi : MEZİTLİ
Mahallesi : DAVULTEPE

RÖLEVE KROKİSİ

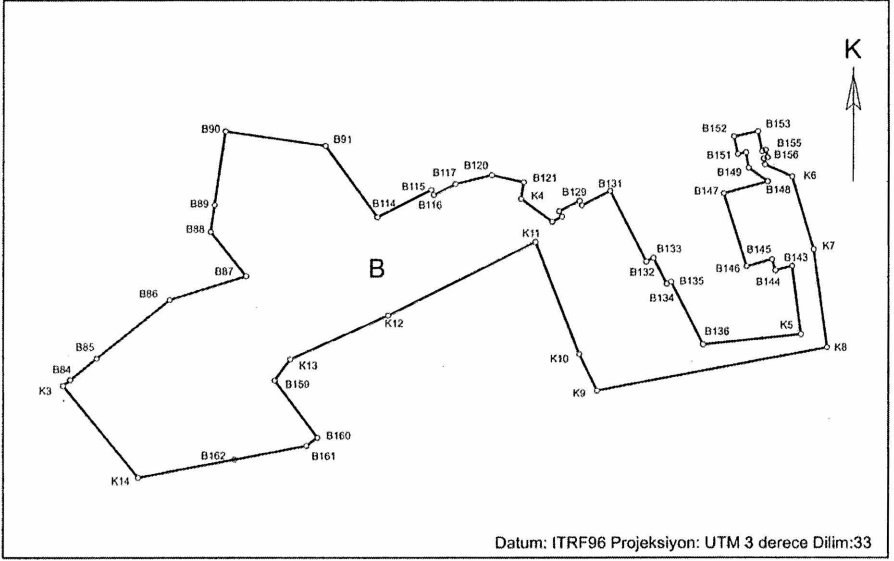

Datum: ITRF96 Projeksiyon: UTM 3 derece Dilim:33

NoktaNo	Y	X	NoktaNo	Y	X
B84	631863.19	4066835.27	B85	631867.37	4066838.70
B86	631879.13	4066848.13	B87	631891.29	4066851.96
B88	631885.65	4066859.03	B89	631886.27	4066863.31
B90	631888.00	4066875.17	B91	631903.97	4066872.84
B114	631912.32	4066861.37	B115	631920.97	4066865.76
B116	631921.37	4066864.97	B117	631924.82	4066866.72
B120	631930.64	4066868.14	B121	631935.77	4066866.99
B126	631940.34	4066860.68	B127	631941.91	4066861.48
B128	631941.45	4066862.38	B129	631944.73	4066864.04
B130	631945.10	4066863.31	B131	631949.68	4066865.64
B132	631955.46	4066854.28	B133	631956.62	4066854.87
B134	631958.71	4066850.75	B135	631959.37	4066851.09
B136	631964.49	4066841.02	B143	631978.64	4066853.62
B144	631975.97	4066852.94	B145	631975.44	4066854.67
B146	631971.40	4066853.55	B147	631967.71	4066865.22
B148	631974.75	4066867.15	B149	631971.71	4066869.33
B150	631971.28	4066871.82	B151	631969.97	4066871.56
B152	631969.34	4066874.41	B153	631973.17	4066875.23
B154	631973.86	4066872.02	B155	631974.43	4066872.22
B156	631974.72	4066871.00	B157	631974.12	4066870.83
B158	631974.32	4066869.89	B159	631895.85	4066835.20
B160	631902.76	4066826.03	B161	631900.98	4066824.70
K3	631862.03	4066834.34	K4	631935.32	4066864.35
K5	631980.12	4066842.68	K6	631978.63	4066867.95
K7	631982.15	4066856.26	K8	631984.37	4066840.58
K9	631947.60	4066833.58	K10	631944.71	4066839.46
K11	631937.66	4066857.41	K12	631914.07	4066845.67
K13	631898.36	4066838.60	K14	631874.07	4066819.58

Ada	Parsel	Noktalar	HesapAlan
584	13-B	B90,B91,B114,B115,B116,B117, B120,B121,K4,B126,B127,B128, B129,B130,B131,B132,B133,B134, B135,B136,K5,B143,B144,B145, B146,B147,B148,B149,B150,B151, B152,B153,B154,B155,B156,B157, B158,K6,K7,K8,K9,K10,K11,K12, K13,B159,B160,B161,K14,K3,B84, B85,B86,B87,B88,B89	2632.43

İli : MERSİN
İlçesi : MUT
Mahallesi : BARABANLI

RÖLEVE KROKİSİ

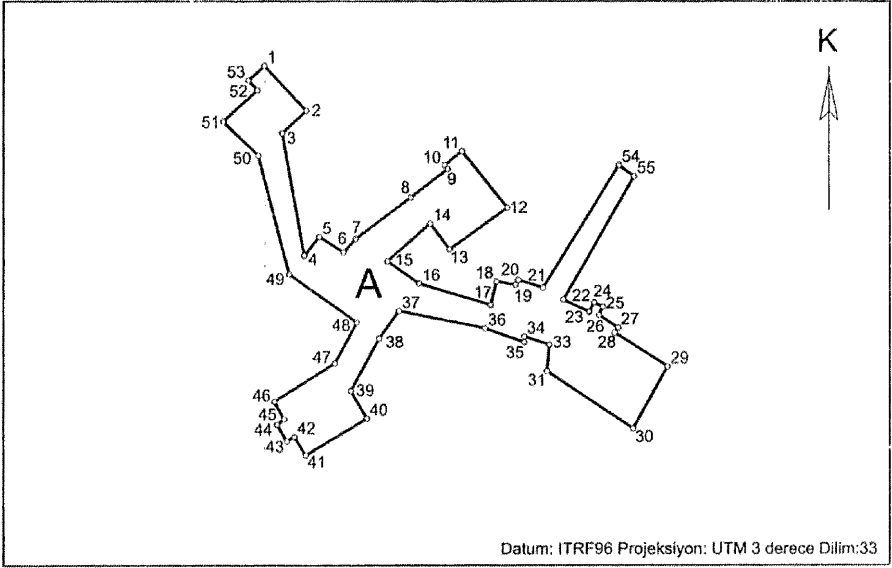

Ada	Parsel	Noktalar	HesapAlan
103	4-A	1,2,3,4,5,6,7,8,9,10,11,12,13, 14,15,16,17,18,19,20,21,54,55, 22,23,24,25,26,27,28,29,30,31, 33,34,35,36,37,38,39,40,41,42, 43,44,45,46,47,48,49,50,51,52, 53	1249.76

NoktaNo	Y	X	NoktaNo	Y	X
1	536953.11	4058773.29	2	536960.25	4058765.72
3	536956.16	4058761.95	4	536959.91	4058741.34
5	536962.47	4058744.51	6	536966.58	4058741.89
7	536968.69	4058744.16	8	536978.14	4058751.14
9	536984.43	4058755.92	10	536983.95	4058756.62
11	536986.87	4058758.86	12	536994.55	4058749.42
13	536984.79	4058742.39	14	536981.46	4058746.76
15	536974.14	4058740.39	16	536979.59	4058736.62
17	536991.74	4058732.99	18	536992.72	4058736.96
19	536995.33	4058736.41	20	536996.40	4058737.21
21	537000.61	4058735.89	22	537004.08	4058733.88
23	537008.37	4058731.79	24	537009.25	4058733.35
25	537010.73	4058732.64	26	537010.09	4058731.20
27	537013.28	4058729.11	28	537012.71	4058728.28
29	537021.64	4058722.57	30	537015.82	4058712.08
31	537001.28	4058721.79	33	537001.69	4058726.24
34	536997.39	4058727.63	35	536997.39	4058726.68
36	536990.76	4058729.02	37	536976.15	4058731.96
38	536972.71	4058727.31	39	536967.86	4058718.46
40	536970.62	4058713.82	41	536960.16	4058707.60
42	536958.26	4058710.73	43	536956.98	4058709.94
44	536955.31	4058712.77	45	536956.49	4058713.68
46	536954.82	4058716.67	47	536965.10	4058723.10
48	536968.89	4058730.01	49	536957.36	4058738.17
50	536952.08	4058758.19	51	536946.15	4058763.88
52	536951.92	4058769.18	53	536950.44	4058770.83
54	537013.39	4058756.54	55	537015.95	4058754.68

İli : MERSİN
İlçesi : MUT
Mahallesi : BARABANLI

RÖLEVE KROKİSİ

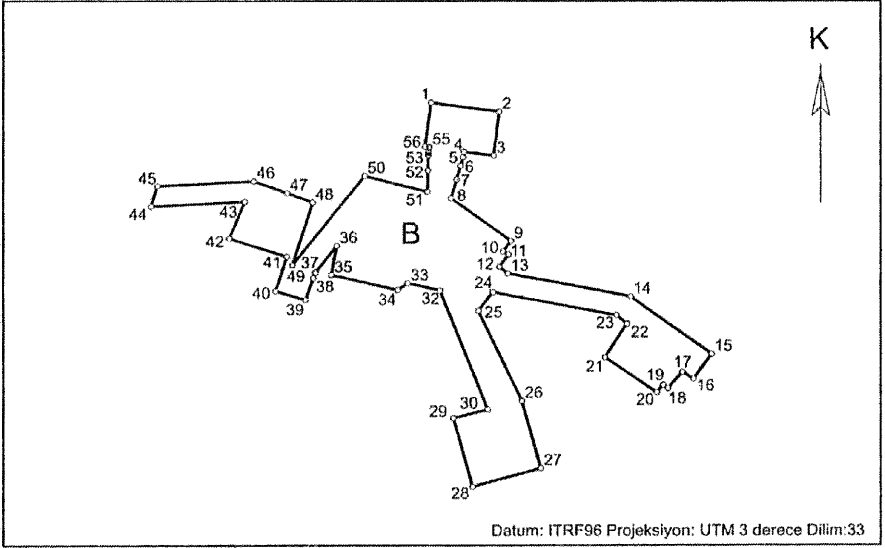

Ada	Parsel	Noktalar	HesapAlan
103	4-B	45,46,47,48,49,50,51,52,53,54,55,56,1,2,3,4,5,6,7,8,9,10,11,12,13,14,15,16,17,18,19,20,21,22,23,24,25,26,27,28,29,30,32,33,34,35,36,37,38,39,40,41,42,43,44	1336.66

NoktaNo	Y	X	NoktaNo	Y	X
1	537089.38	4058776.30	2	537101.02	4058774.73
3	537100.06	4058767.04	4	537094.98	4058767.73
5	537094.85	4058766.79	6	537094.41	4058765.30
7	537093.72	4058762.90	8	537092.77	4058759.64
9	537103.06	4058752.14	10	537101.63	4058750.29
11	537102.62	4058749.77	12	537101.04	4058747.59
13	537102.47	4058746.43	14	537123.61	4058742.39
15	537137.43	4058732.28	16	537134.31	4058727.97
17	537132.46	4058729.11	18	537130.06	4058726.31
19	537129.25	4058726.88	20	537128.15	4058725.57
21	537119.14	4058731.69	22	537122.97	4058737.58
23	537121.14	4058739.09	24	537099.93	4058743.16
25	537097.40	4058739.89	26	537104.91	4058724.11
27	537108.13	4058712.34	28	537096.45	4058709.14
29	537093.17	4058721.13	30	537099.04	4058722.62
32	537090.88	4058743.45	33	537085.37	4058744.72
34	537083.65	4058743.54	35	537072.23	4058746.19
36	537073.14	4058751.31	37	537069.47	4058746.61
38	537069.12	4058745.64	39	537067.77	4058741.82
40	537062.57	4058743.36	41	537064.52	4058749.39
42	537054.63	4058752.60	43	537057.35	4058759.03
44	537041.14	4058758.22	45	537042.22	4058761.78
46	537058.88	4058762.65	47	537064.58	4058760.55
48	537069.03	4058758.91	49	537065.47	4058747.91
50	537077.96	4058763.54	51	537088.74	4058760.78
52	537088.86	4058764.47	53	537088.95	4058767.13
54	537088.97	4058767.61	55	537089.10	4058768.52
56	537088.34	4058768.62			

İli : MERSİN
İlçesi : SİLİFKE
Köyü : HACIŞAKLI

RÖLEVE KROKİSİ

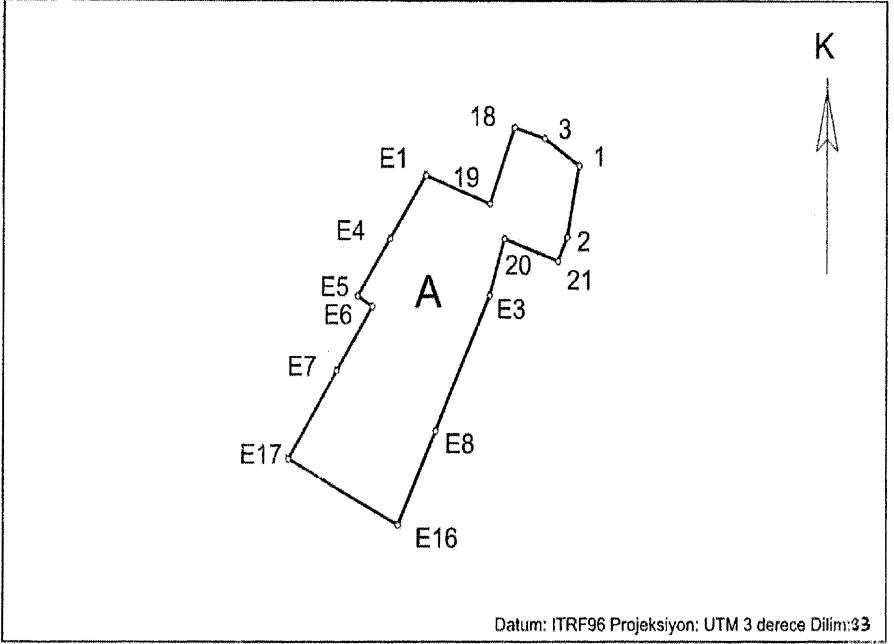

Datum: ITRF96 Projeksiyon: UTM 3 derece Dilim:33

Ada	Parsel	Noktalar	HesapAlan
	2863-A	E1,19,18,3,1,2,21,20,E3,E8, E16,E17,E7,E6,E5,E4	290.55

NoktaNo	Y	X	NoktaNo	Y	X
1	559676.66	4006424.62	2	559675.64	4006419.22
3	559673.63	4006426.66	18	559671.01	4006427.49
19	559668.87	4006421.73	20	559670.15	4006419.09
21	559674.84	4006417.38	E1	559663.32	4006423.89
E3	559668.85	4006414.80	E4	559660.25	4006419.07
E5	559657.46	4006414.76	E6	559658.74	4006413.95
E7	559655.66	4006409.08	E8	559664.19	4006404.52
E16	559660.97	4006397.42	E17	559651.44	4006402.41

İli : MERSİN
İlçesi : SİLİFKE
Köyü : HACIŞAKLI

RÖLEVE KROKİSİ

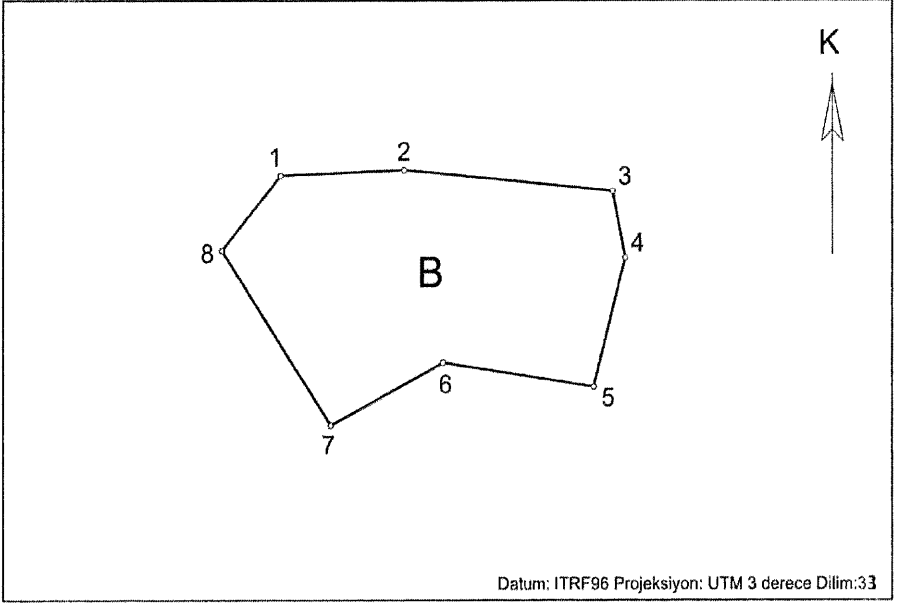

Ada	Parsel	Noktalar	HesapAlan
	B (2863-)	1,2,3,4,5,6,7,8	514.66

NoktaNo	Y	X	NoktaNo	Y	X
1	559977.12	4007147.66	2	559987.79	4007148.12
3	560005.86	4007146.41	4	560006.95	4007140.98
5	560004.23	4007130.56	6	559991.15	4007132.51
7	559981.44	4007127.42	8	559972.01	4007141.56

İli : MERSİN
İlçesi : TOROSLAR
Mahallesi : KEPIRLİ

RÖLEVE KROKİSİ

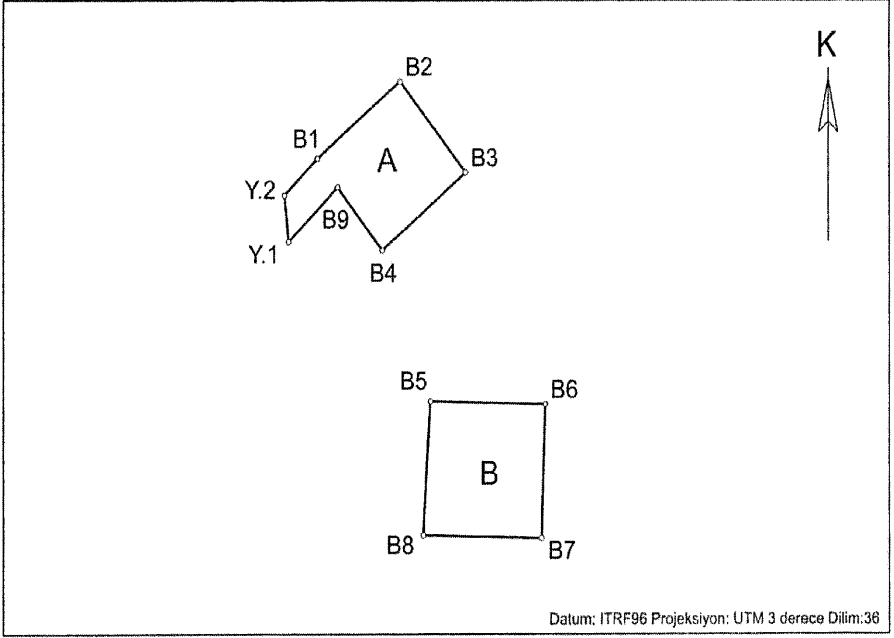

Ada	Parsel	Noktalar	HesapAlan
463	1-A	Y.2,B1,B2,B3,B4,B9,Y.1	113.00
463	1-B	B5,B6,B7,B8	119.10

NoktaNo	Y	X	NoktaNo	Y	X
B1	369796.52	4092240.54	B2	369604.25	4092246.91
B3	369810.34	4092239.39	B4	369802.60	4092233.02
B5	369807.07	4092220.60	B6	369817.76	4092220.36
B7	369817.40	4092209.39	B8	369806.39	4092209.64
B9	369798.42	4092238.19	Y.1	369793.83	4092233.71
Y.2	369793.45	4092237.54			

İli : MUĞLA
İlçesi : FETHİYE
Mahallesi : BOZYER

RÖLEVE KROKİSİ

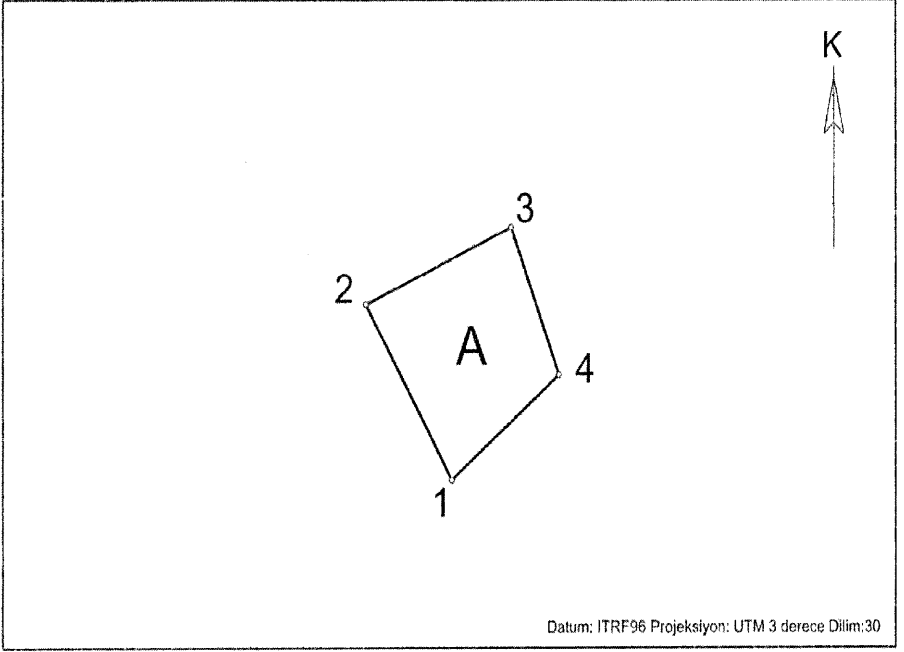

Ada	Parsel	Noktalar	HesapAlan
152	1-A	1,2,3,4	320.96

NoktaNo	Y	X	NoktaNo	Y	X
1	432480.19	4053403.42	2	432470.07	4053421.42
3	432487.21	4053429.34	4	432492.88	4053414.20

İli : MUĞLA
İlçesi : FETHİYE
Mahallesi : BOZYER

RÖLEVE KROKİSİ

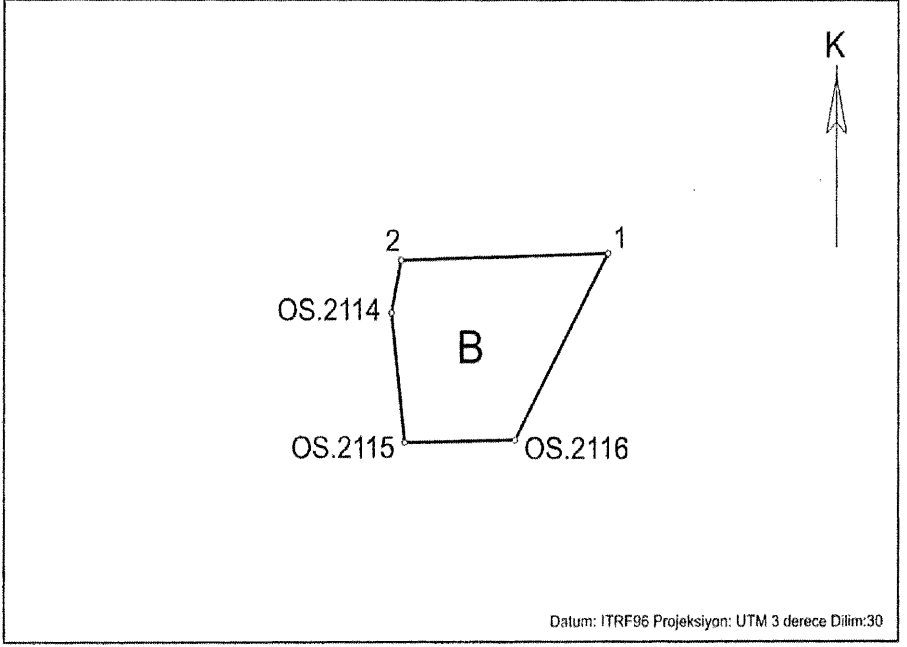

Ada	Parsel	Noktalar	HesapAlan
152	1-B	1,OS.2116,OS.2115,OS.2114,2	279.21

NoktaNo	Y	X	NoktaNo	Y	X
1	431668.05	4054411.46	2	431646.86	4054410.88
OS.2114	431645.88	4054406.09	OS.2115	431647.23	4054394.34
OS.2116	431658.55	4054394.54			

İli : MUĞLA
İlçesi : FETHİYE
Mahallesi : BOZYER

RÖLEVE KROKİSİ

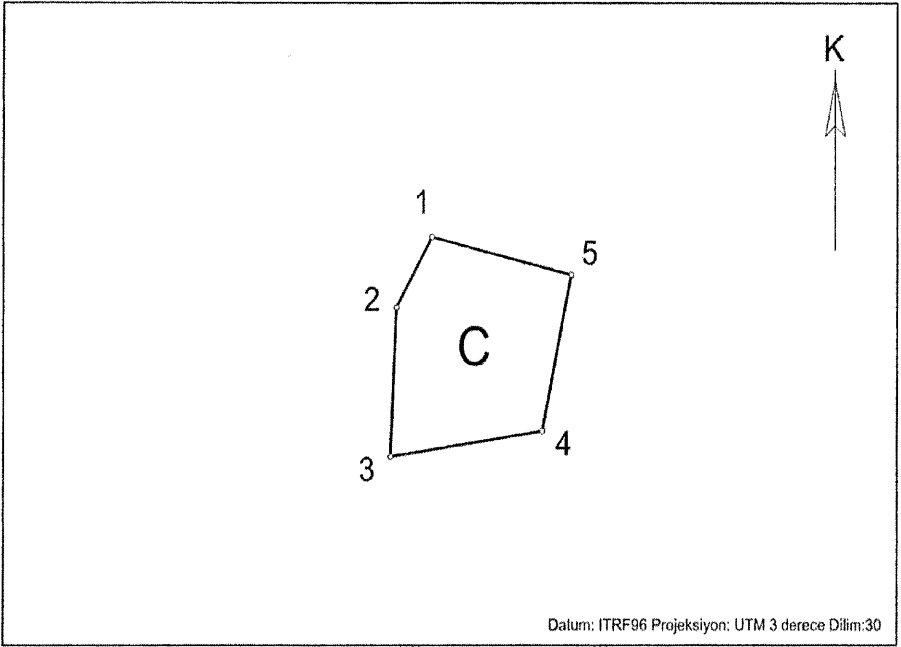

Datum: ITRF96 Projeksiyon: UTM 3 derece Dilim:30

Ada	Parsel	Noktalar	HesapAlan
152	1-C	1,5,4,3,2	363.92

NoktaNo	Y	X	NoktaNo	Y	X
1	432202.98	4053589.69	2	432198.84	4053582.40
3	432198.16	4053567.00	4	432215.98	4053569.66
5	432219.38	4053585.77			

İli : MUĞLA
İlçesi : FETHİYE
Mahallesi : BOZYER

RÖLEVE KROKİSİ

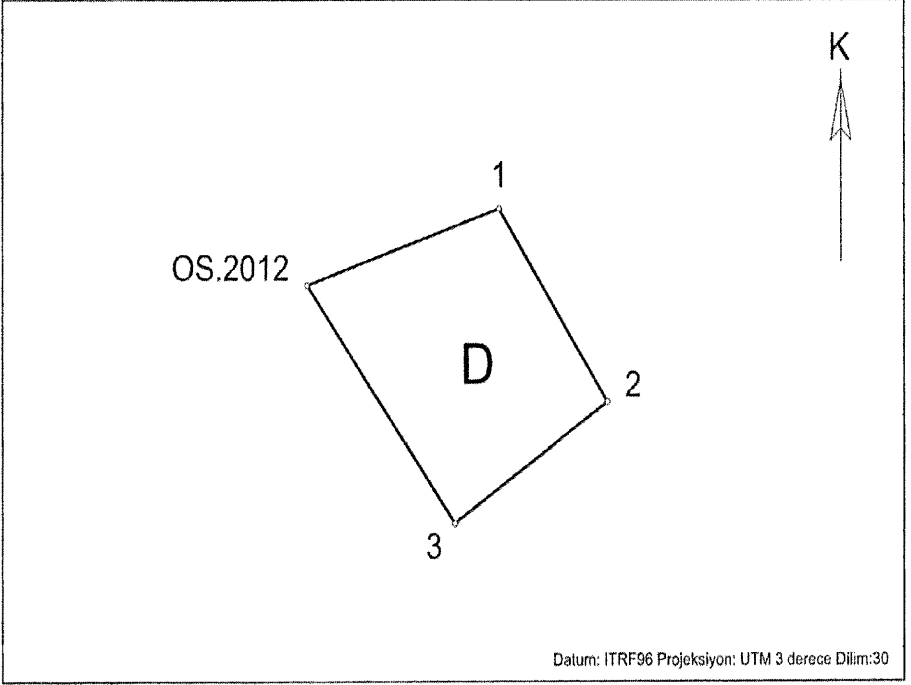

Ada	Parsel	Noktalar	HesapAlan
152	1-D	1,2,3,OS.2012	565.93

NoktaNo	Y	X	NoktaNo	Y	X
1	432513.48	4055254.65	2	432526.14	4055235.81
3	432508.35	4055224.01	OS.2012	432491.11	4055247.22

İli : MUĞLA
İlçesi : FETHİYE
Mahallesi : BOZYER

RÖLEVE KROKİSİ

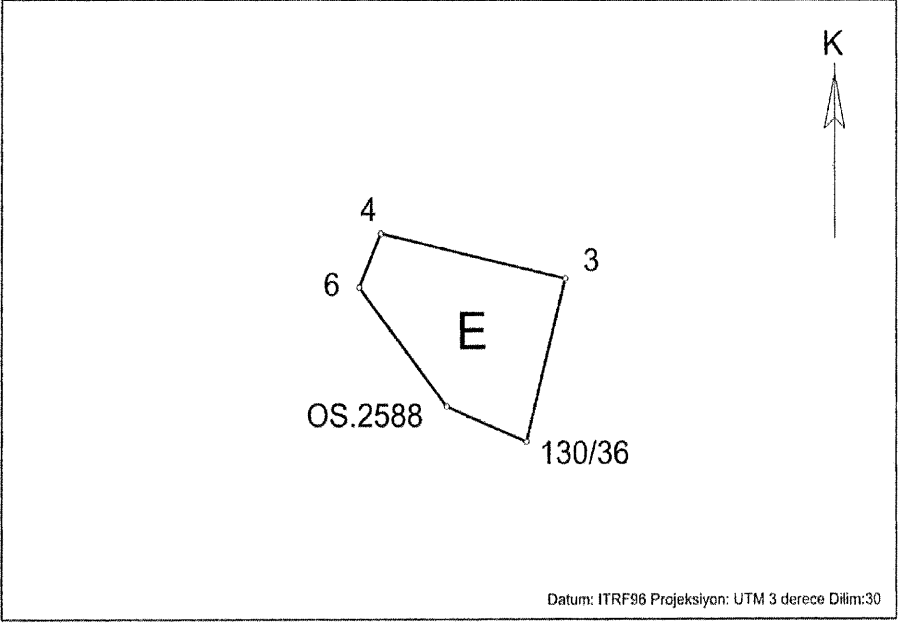

Ada	Parsel	Noktalar	HesapAlan
152	1-E	3,130/36,OS.2588,6,4	320.61

NoktaNo	Y	X	NoktaNo	Y	X
3	431642.68	4053860.99	4	431620.90	4053865.85
6	431618.37	4053860.05	130/36	431638.08	4053843.49
OS.2588	431628.65	4053847.28			

İli : MUĞLA
İlçesi : FETHİYE
Mahallesi : BOZYER

RÖLEVE KROKİSİ

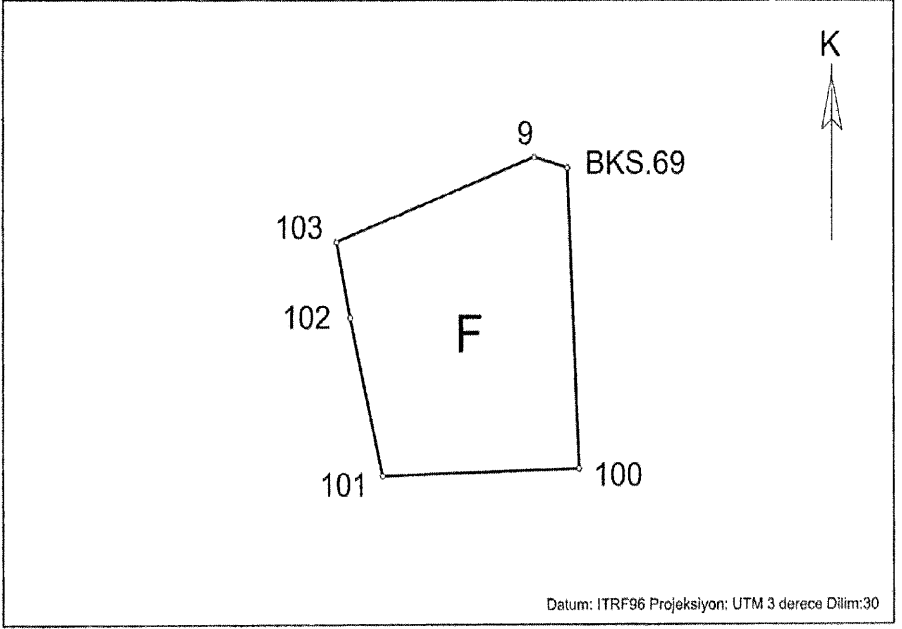

Ada	Parsel	Noktalar	HesapAlan
152	1-F	100,101,102,103,9,BKS.69	766.08

NoktaNo	Y	X	NoktaNo	Y	X
9	435776.01	4056814.86	100	435781.35	4056781.75
101	435758.15	4056781.00	102	435754.29	4056797.77
103	435752.66	4056805.89	BKS.69	435779.98	4056813.75

İli : MUĞLA
İlçesi : FETHİYE
Mahallesi : BOZYER

RÖLEVE KROKİSİ

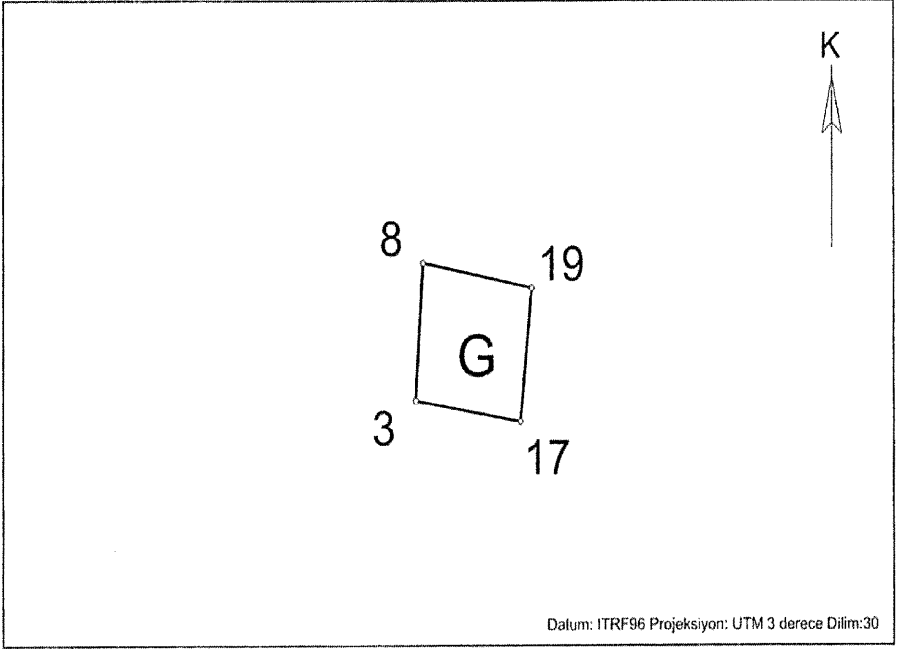

Ada	Parsel	Noktalar	HesapAlan
152	1-G	3,8,19,17	85.84

NoktaNo	Y	X	NoktaNo	Y	X
3	432512.04	4054728.45	8	432512.65	4054738.29
17	432520.62	4054726.95	19	432521.53	4054736.50

İli : MUĞLA
İlçesi : FETHİYE
Mahallesi : BOZYER

RÖLEVE KROKİSİ

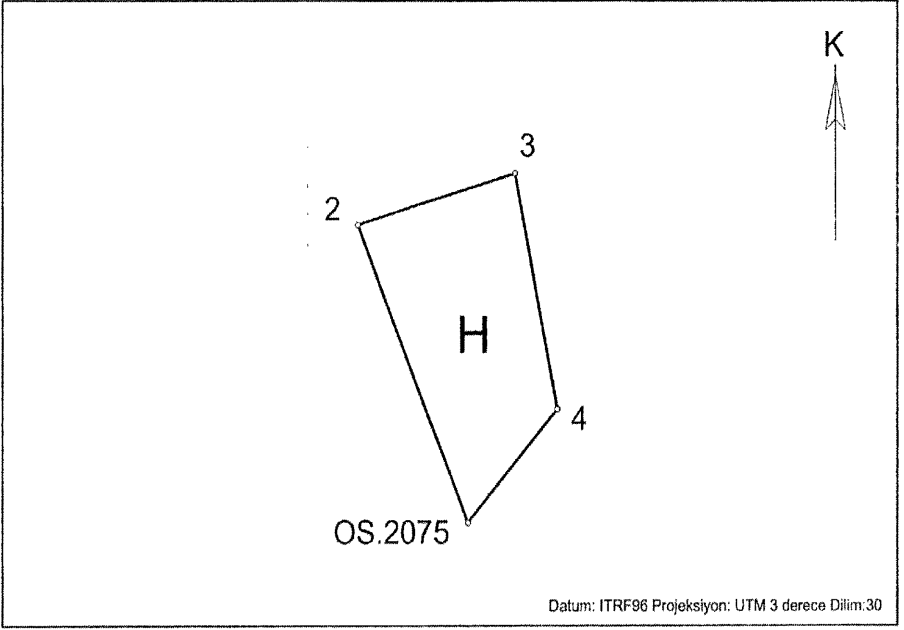

Ada	Parsel	Noktalar	HesapAlan
152	1-H	2,3,4,OS.2075	487.33

NoktaNo	Y	X	NoktaNo	Y	X
2	432297.17	4053907.15	3	432315.60	4053912.58
4	432320.56	4053887.53	OS.2075	432310.13	4053875.50

İli : MUĞLA
İlçesi : FETHİYE
Mahallesi : YAKACIK

RÖLEVE KROKİSİ

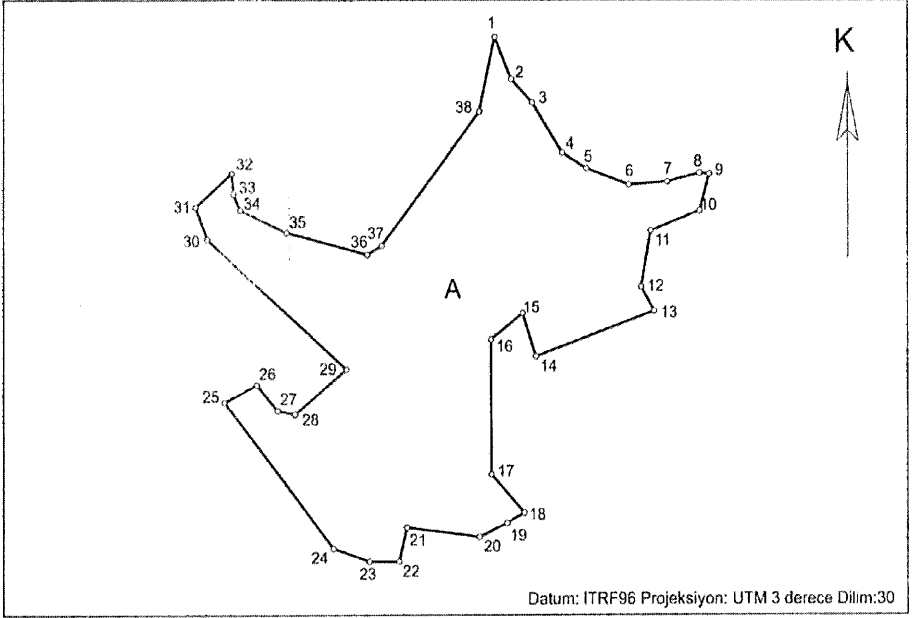

Ada	Parsel	Noktalar	HesapAlan
225	1-A	31,32,33,34,35,36,37,38,1,2,3,4,5,6,7,8,9,10,11,12,13,14,15,16,17,18,19,20,21,22,23,24,25,26,27,28,29,30	189085.43

NoktaNo	Y	X	NoktaNo	Y	X
1	434147.55	4057835.19	2	434170.04	4057780.83
3	434199.08	4057750.74	4	434240.43	4057686.37
5	434274.19	4057666.74	6	434333.33	4057645.80
7	434386.71	4057649.73	8	434430.41	4057660.72
9	434443.61	4057659.64	10	434430.59	4057612.45
11	434363.69	4057586.90	12	434350.51	4057515.02
13	434368.42	4057484.09	14	434204.23	4057425.74
15	434185.90	4057481.48	16	434142.56	4057447.51
17	434143.13	4057274.75	18	434188.25	4057226.11
19	434164.58	4057212.83	20	434126.51	4057195.26
21	434026.59	4057207.36	22	434016.04	4057164.02
23	433975.04	4057164.02	24	433925.88	4057180.31
25	433776.69	4057367.62	26	433821.09	4057389.42
27	433849.43	4057356.77	28	433872.96	4057352.22
29	433943.73	4057409.06	30	433753.02	4057575.86
31	433736.90	4057616.99	32	433786.64	4057660.61
33	433788.98	4057634.15	34	433797.86	4057613.30
35	433861.69	4057584.66	36	433972.41	4057556.37
37	433992.50	4057568.02	38	434126.35	4057739.26

İli : MUĞLA
İlçesi : MENTEŞE
Mahallesi : EMİRBEYAZIT

RÖLEVE KROKİSİ

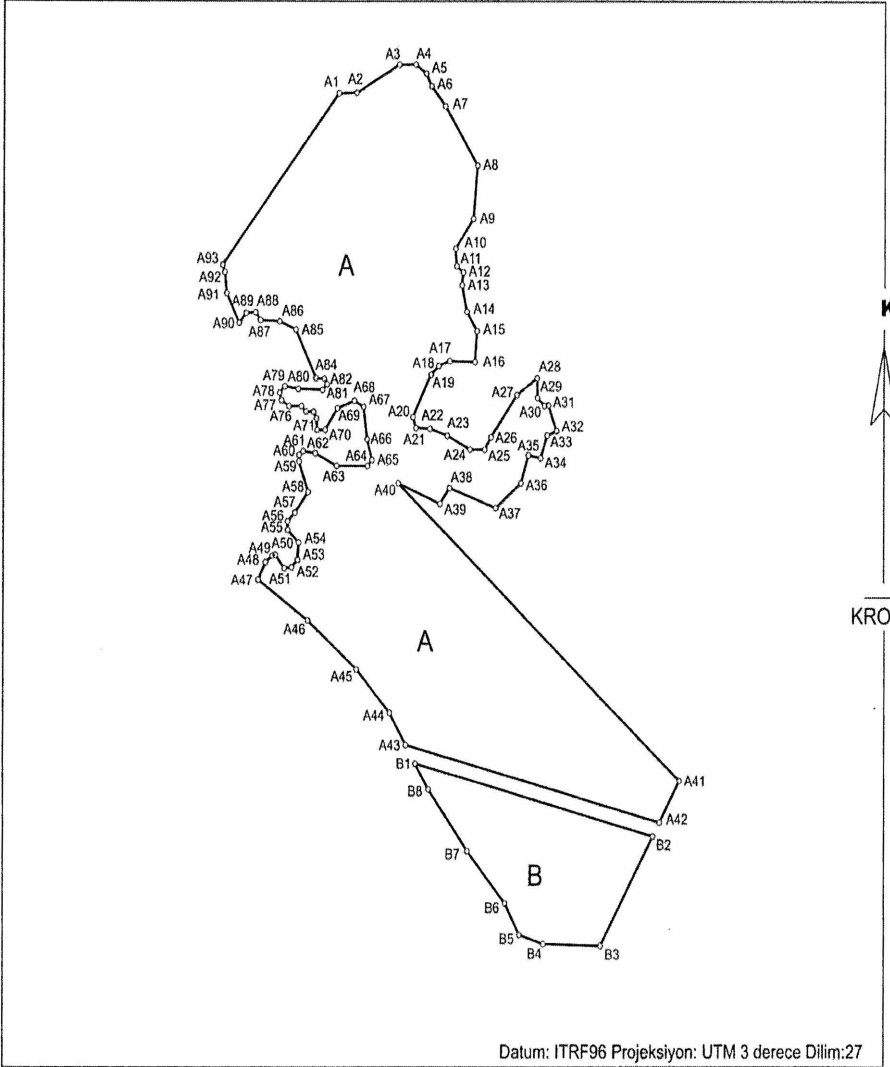

Datum: ITRF96 Projeksiyon: UTM 3 derece Dilim:27

İli : MUĞLA
İlçesi : MENTEŞE
Mahallesi : EMİRBEYAZIT

KOORDİNELİ ÖZET ALAN ÇİZELGESİ

Datum: ITRF96 Projeksiyon: UTM 3 derece Dilim:27

NoktaNo	Y	X	NoktaNo	Y	X
A1	620418.39	4118293.24	A2	620448.89	4118293.82
A3	620523.63	4118334.22	A4	620551.56	4118334.32
A5	620569.69	4118321.42	A6	620578.78	4118303.24
A7	620602.41	4118274.96	A8	620657.76	4118190.11
A9	620650.81	4118114.64	A10	620620.11	4118072.22
A11	620622.13	4118047.58	A12	620633.44	4118038.69
A13	620631.42	4118020.10	A14	620639.90	4117982.93
A15	620657.28	4117955.46	A16	620654.05	4117911.83
A17	620610.48	4117913.11	A18	620591.96	4117906.04
A19	620578.83	4117893.58	A20	620548.19	4117833.31
A21	620553.24	4117817.83	A22	620577.15	4117816.82
A23	620606.78	4117808.72	A24	620645.83	4117786.85
A25	620671.08	4117786.85	A26	620681.71	4117804.68
A27	620726.37	4117864.77	A28	620761.21	4117888.85
A29	620761.91	4117860.56	A30	620774.07	4117849.33
A31	620780.87	4117849.96	A32	620794.64	4117813.53
A33	620778.51	4117807.09	A34	620767.63	4117774.63
A35	620746.26	4117779.02	A36	620733.63	4117739.23
A37	620690.30	4117704.10	A38	620610.65	4117732.25
A39	620594.77	4117709.86	A40	620523.23	4117738.81
A41	621007.02	4117315.24	A42	620972.71	4117256.36
A43	620537.01	4117367.64	A44	620509.27	4117413.45
A45	620450.52	4117475.29	A46	620367.02	4117544.87
A47	620282.29	4117602.18	A48	620294.64	4117626.87
A49	620306.14	4117636.41	A50	620311.47	4117637.53
A51	620326.90	4117618.46	A52	620339.25	4117619.86
A53	620349.35	4117630.52	A54	620351.31	4117654.93
A55	620332.51	4117672.60	A56	620332.23	4117684.95
A57	620344.86	4117697.58	A58	620367.30	4117726.19
A59	620351.70	4117769.84	A60	620351.70	4117779.13
A61	620358.57	4117784.38	A62	620379.18	4117781.55
A63	620415.54	4117763.78	A64	620469.27	4117763.37
A65	620477.35	4117771.86	A66	620468.46	4117801.75
A67	620462.40	4117847.81	A68	620446.24	4117856.30
A69	620417.16	4117845.79	A70	620395.91	4117814.89
A71	620382.22	4117815.00	A72	620381.38	4117831.27
A73	620376.05	4117840.81	A74	620363.42	4117841.10
A75	620355.57	4117848.95	A76	620334.24	4117848.67
A77	620321.34	4117857.09	A78	620317.97	4117867.75
A79	620326.95	4117877.01	A80	620349.95	4117873.36
A81	620391.48	4117871.96	A82	620399.33	4117880.09
A83	620394.29	4117887.95	A84	620380.26	4117888.79
A85	620345.75	4117957.53	A86	620317.69	4117969.31
A87	620284.86	4117971.00	A88	620276.73	4117982.22
A89	620260.73	4117981.10	A90	620248.68	4117967.11
A91	620227.28	4118009.19	A92	620224.03	4118039.07
A93	620220.25	4118049.31	B1	620553.28	4117340.78
B2	620961.36	4117236.55	B3	620871.98	4117080.57
B4	620773.56	4117083.23	B5	620731.86	4117096.09
B6	620707.18	4117141.33	B7	620642.24	4117215.54
B8	620575.76	4117303.67			

Ada	Parsel	Noktalar	HesapAlan
(1819-1) (1816-28)	A	A1,A2,A3,A4,A5,A6,A7,A8,A9, A10,A11,A12,A13,A14,A15,A16, A17,A18,A19,A20,A21,A22,A23, A24,A25,A26,A27,A28,A29,A30, A31,A32,A33,A34,A35,A36,A37, A38,A39,A40,A41,A42,A43,A44, A45,A46,A47,A48,A49,A50,A51, A52,A53,A54,A55,A56,A57,A58, A59,A60,A61,A62,A63,A64,A65, A66,A67,A68,A69,A70,A71,A72, A73,A74,A75,A76,A77,A78,A79, A80,A81,A82,A83,A84,A85,A86, A87,A88,A89,A90,A91,A92,A93	330856.63
1819	1-B	B1,B2,B3,B4,B5,B6,B7,B8	52806.33

İli : MUĞLA

İlçesi : MENTEŞE

Köy/Mahalle : KÖTEKLİ

RÖLEVE KROKİSİ

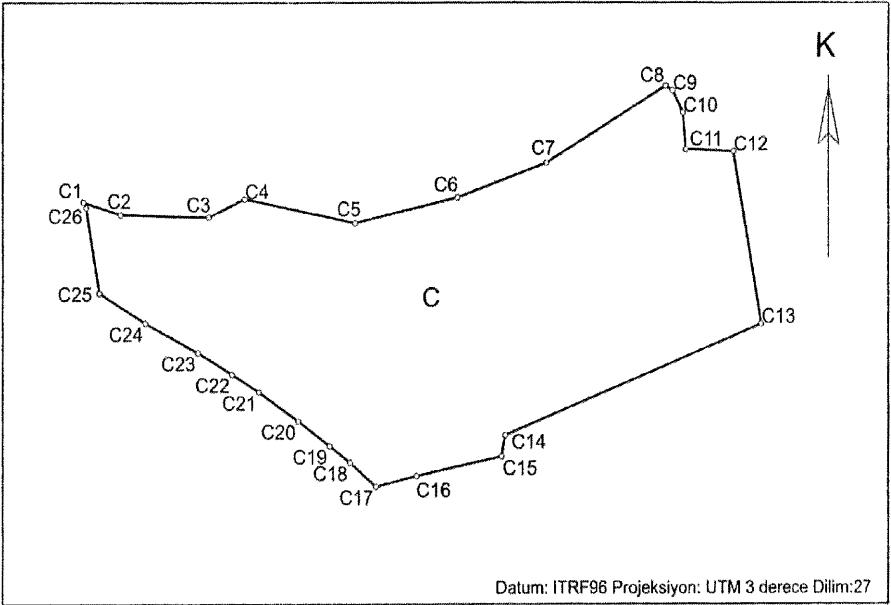

Ada	Parsel	Noktalar	HesapAlan
161	3-C	C1,C2,C3,C4,C5,C6,C7,C8,C9, C10,C11,C12,C13,C14,C15,C16, C17,C18,C19,C20,C21,C22,C23, C24,C25,C26	163251.15

NoktaNo	Y	X	NoktaNo	Y	X
C1	620731.86	4117096.09	C2	620773.56	4117083.23
C3	620871.98	4117080.57	C4	620912.09	4117099.38
C5	621034.47	4117074.73	C6	621148.35	4117101.08
C7	621246.62	4117136.96	C8	621379.13	4117216.79
C9	621386.88	4117212.12	C10	621398.45	4117189.25
C11	621401.48	4117151.12	C12	621454.56	4117149.20
C13	621485.86	4116970.27	C14	621201.08	4116855.10
C15	621197.16	4116832.99	C16	621103.36	4116813.08
C17	621058.08	4116801.97	C18	621028.95	4116826.71
C19	621006.17	4116843.84	C20	620971.36	4116869.56
C21	620928.00	4116899.71	C22	620898.13	4116918.06
C23	620860.25	4116940.38	C24	620801.42	4116970.81
C25	620749.54	4117001.82	C26	620735.01	4117090.31

İli : SAMSUN
İlçesi : ATAKUM
Mahallesi : ERIKLİ

RÖLEVE KROKİSİ

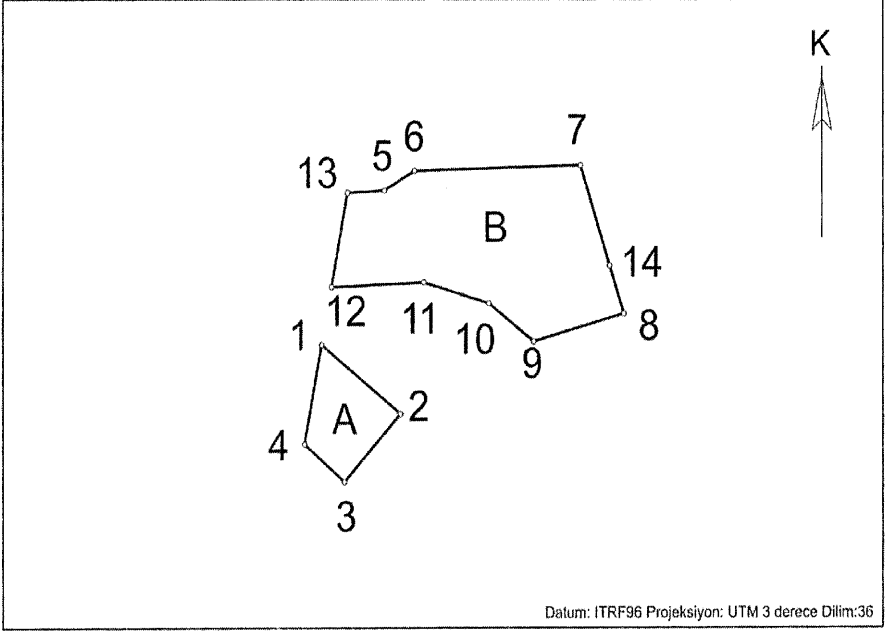

Ada	Parsel	Noktalar	HesapAlan
307	1-A	1,2,3,4	206.46
307	1-B	13,5,6,7,14,8,9,10,11,12	1031.42

NoktaNo	Y	X	NoktaNo	Y	X
1	506651.16	4580704.32	2	506665.66	4580693.07
3	506655.35	4580682.07	4	506648.03	4580688.15
5	506662.69	4580729.29	6	506668.21	4580732.47
7	506698.78	4580733.35	8	506706.75	4580709.37
9	506690.08	4580704.84	10	506681.83	4580711.06
11	506669.89	4580714.45	12	506652.97	4580713.70
13	506655.92	4580728.93	14	506704.11	4580717.11

İli : SAMSUN
İlçesi : ATAKUM
Mahallesi : ERİKLİ

RÖLEVE KROKİSİ

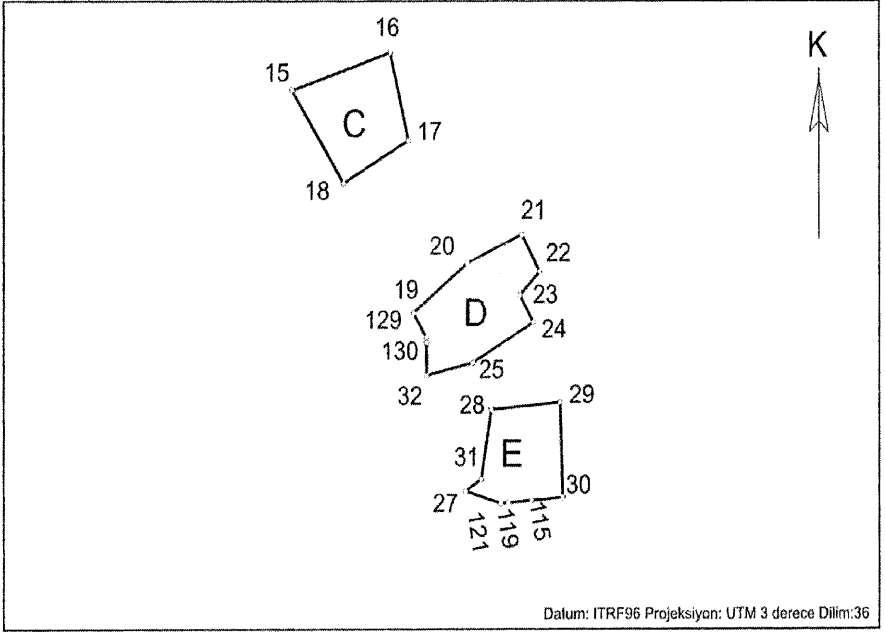

Datum: ITRF96 Projeksiyon: UTM 3 derece Dilim:36

Ada	Parsel	Noktalar	HesapAlan
307	1-C	16,17,18,15	263.79
307	1-D	20,21,22,23,24,25,32,188/130, 188/129,19	296.40
307	1-E	27,31,28,29,30,188/115, 188/119,188/121	220.00

NoktaNo	Y	X	NoktaNo	Y	X
15	507411.60	4580801.15	16	507429.72	4580807.28
17	507433.10	4580793.00	18	507421.01	4580786.04
19	507433.99	4580764.99	20	507443.92	4580773.10
21	507453.94	4580777.71	22	507457.26	4580771.71
23	507453.56	4580767.91	24	507456.06	4580763.48
25	507444.93	4580756.90	27	507443.59	4580736.09
28	507448.33	4580749.30	29	507461.10	4580750.53
30	507461.54	4580735.06	31	507446.51	4580738.00
32	507436.43	4580754.89	188/115	507455.76	4580734.56
188/119	507451.44	4580734.19	188/121	507450.11	4580734.08
188/129	507436.43	4580761.03	188/130	507436.43	4580760.18

İLİ : TOKAT
İLÇESİ : NIKSAR
BELDESİ : GÜRÇEŞME

NoktaNo	Y	X	NoktaNo	Y	X
1	570856.99	4494397.97	2	570931.68	4494219.32
3	570835.07	4494186.54	4	570701.68	4494085.89
5	570682.45	4494078.49	6	570676.54	4494084.04
7	570653.82	4494055.67	8	570628.62	4494021.32
9	570501.35	4493915.16	10	570312.64	4493801.73
11	570254.72	4493765.48	12	570252.77	4493742.84
13	570239.72	4493724.92	14	570195.28	4493703.59
15	570136.73	4493760.29	16	570153.13	4493805.86
17	570179.86	4493821.62	18	570215.88	4493843.14
19	570252.95	4493874.44	20	570284.23	4493918.64
21	570293.82	4493946.57	22	570292.56	4493989.10
23	570246.97	4494091.70	24	570262.84	4494146.62
25	570271.91	4494157.95	26	570307.18	4494167.53
27	570316.50	4494162.74	28	570338.16	4494151.66
29	570367.39	4494137.80	30	570382.75	4494131.75
31	570420.04	4494151.40	32	570428.86	4494157.45
33	570429.86	4494164.50	34	570425.58	4494175.08
35	570471.43	4494190.70	36	570554.64	4494199.40
37	570702.44	4494262.25	38	570698.67	4494247.64
39	570683.80	4494209.34	40	570672.21	4494184.66
41	570663.90	4494171.05	42	570650.55	4494155.94
43	570635.94	4494145.10	44	570627.37	4494141.33
45	570617.29	4494140.82	46	570610.49	4494134.78
47	570602.93	4494121.42	48	570595.38	4494109.84
49	570589.83	4494106.06	50	570584.04	4494104.80
51	570579.25	4494105.80	52	570571.19	4494110.34
53	570560.11	4494113.61	54	570550.79	4494113.87
55	570541.97	4494108.07	56	570539.20	4494102.03
57	570538.69	4494086.91	58	570537.69	4494065.75
59	570535.17	4494059.45	60	570526.35	4494049.88
61	570507.96	4494036.78	62	570503.93	4494032.75
63	570497.63	4494032.75	64	570488.56	4494040.81
65	570458.83	4494067.26	66	570452.03	4494066.00
67	570448.51	4494014.06	68	570502.92	4493969.52
69	570508.46	4493971.78	70	570513.75	4493976.32
71	570523.58	4494000.25	72	570542.72	4494010.58
73	570558.85	4494013.85	74	570569.68	4494024.94
75	570612.51	4494048.62	76	570607.15	4494085.00
77	570631.43	4494118.43	78	570642.89	4494124.34
79	570652.87	4494128.41	80	570663.23	4494140.98
81	570668.40	4494150.60	82	570670.91	4494152.33
83	570682.45	4494162.06	84	570693.55	4494176.11
85	570705.01	4494188.31	86	570718.32	4494197.56
87	570721.28	4494207.17	88	570721.28	4494227.14
89	570724.24	4494239.34	90	570728.31	4494247.85
91	570744.58	4494255.98	92	570749.38	4494267.81
93	570751.97	4494279.28	94	570760.48	4494288.89
95	570763.80	4494296.66	96	570762.70	4494307.38
97	570763.07	4494320.32	98	570765.28	4494334.00
99	570767.87	4494339.18	100	570810.40	4494353.23
101	570835.91	4494366.17	102	570847.37	4494371.35
103	570854.77	4494380.22	OS.148	570848.80	4494190.64

İLİ : TOKAT
İLÇESİ : NIKSAR
BELDESİ : GÜRÇEŞME

NoktaNo	Y	X	NoktaNo	Y	X
OS.149	570818.90	4494175.37	OS.2099	570712.43	4494094.76
OS.2100	570809.31	4494168.71	OS.2104	570444.73	4494058.19
OS.2105	570496.90	4493975.56	OS.2106	570475.72	4493954.56
OS.2107	570456.26	4493963.98	OS.2108	570446.58	4493952.14
OS.2109	570426.51	4493944.22	OS.2110	570379.26	4493967.74
OS.2111	570334.00	4494007.13	OS.2112	570344.26	4494020.76
OS.2113	570396.75	4493995.96	OS.2114	570436.37	4493994.63
OS.2115	570464.40	4494004.78			

Ada	Parsel	Noktalar	HesapAlan
101	1-A	1,2,OS.148,3,OS.149,OS.2100, OS.2099,4,5,6,7,8,9,10,11,12, 13,14,15,16,17,18,19,20,21,22, 23,24,25,26,27,28,29,30,31,32, 33,34,35,36,37,38,39,40,41,42, 43,44,45,46,47,48,49,50,51,52, 53,54,55,56,57,58,59,60,61,62, 63,64,65,66,OS.2104,67, OS.2115,OS.2114,OS.2113, OS.2112,OS.2111,OS.2110, OS.2109,OS.2108,OS.2107, OS.2106,OS.2105,68,69,70,71, 72,73,74,75,76,77,78,79,80,81, 82,83,84,85,86,87,88,89,90,91, 92,93,94,95,96,97,98,99,100, 101,102,103	143215.46

İli : TRABZON
İlçesi : AKÇAABAT
Mahallesi : YENİMAHALLE

RÖLEVE KROKİSİ

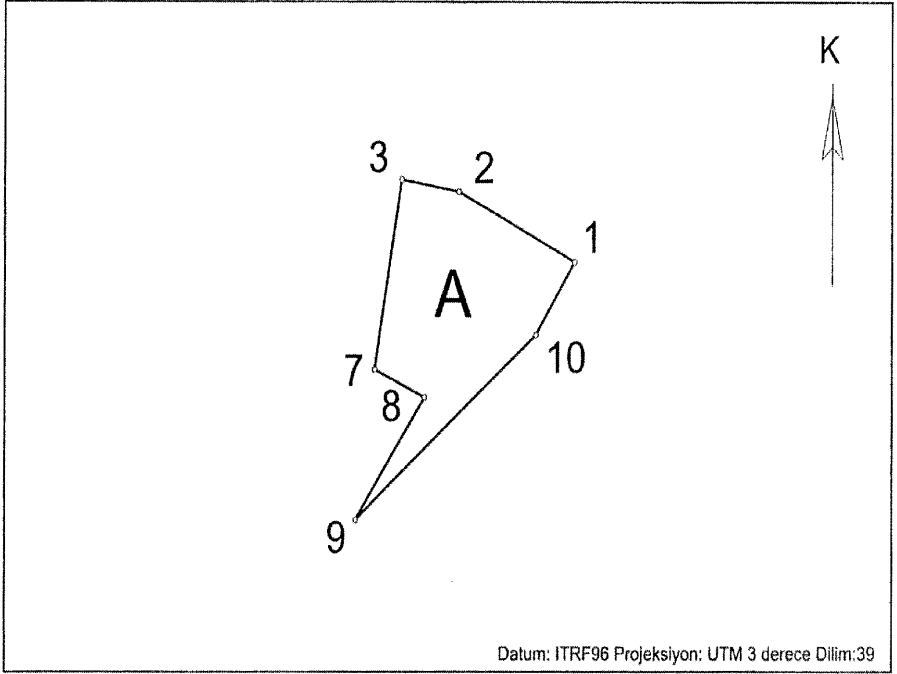

Datum: ITRF96 Projeksiyon: UTM 3 derece Dilim:39

Ada	Parsel	Noktalar	HesapAlan
219	23-A	2,1,10,9,8,7,3	149.37

NoktaNo	Y	X	NoktaNo	Y	X
1	543889.27	4541464.94	2	543880.62	4541469.34
3	543876.34	4541470.11	7	543874.30	4541458.18
8	543878.06	4541456.43	9	543872.85	4541448.74
10	543886.37	4541460.36			

İli : TRABZON
İlçesi : ARAKLI
Mahallesi : BAHÇEÇİK

RÖLEVE KROKİSİ

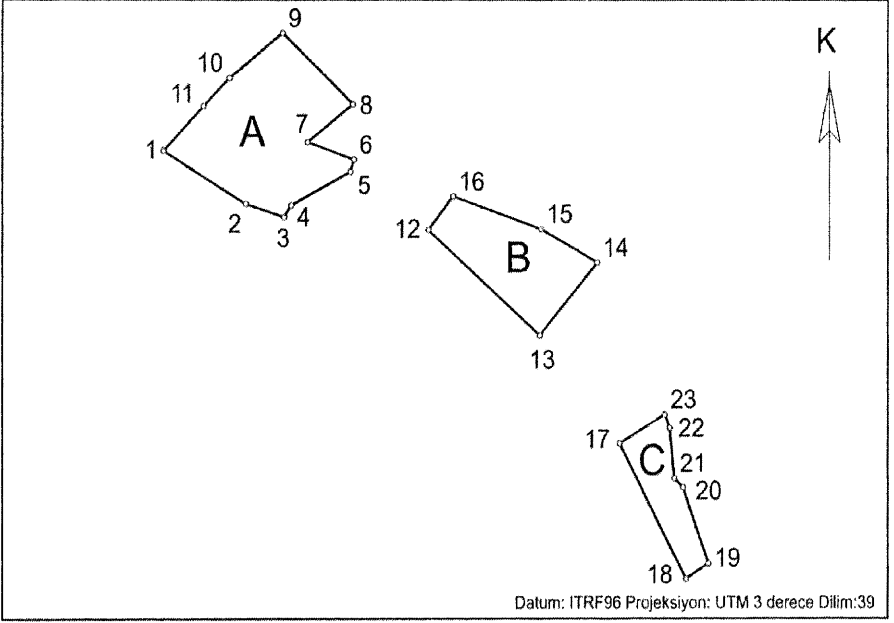

Ada	Parsel	Noktalar	HesapAlan
101	1-A	1,11,10,9,8,7,6,5,4,3,2	137.60
101	1-B	16,15,14,13,12	78.08
101	1-C	23,22,21,20,19,18,17	40.56

NoktaNo	Y	X	NoktaNo	Y	X
1	585116.54	4495004.06	2	585123.83	4494999.74
3	585127.23	4494998.68	4	585127.87	4494999.63
5	585133.18	4495002.36	6	585133.50	4495003.34
7	585129.31	4495004.75	8	585133.41	4495007.81
9	585127.13	4495013.50	10	585122.41	4495009.91
11	585120.12	4495007.64	12	585140.17	4494997.66
13	585150.09	4494989.14	14	585155.22	4494995.02
15	585150.19	4494997.72	16	585142.38	4495000.35
17	585157.24	4494980.45	18	585163.16	4494969.53
19	585165.13	4494970.79	20	585162.88	4494976.91
21	585162.13	4494977.64	22	585161.72	4494981.72
23	585161.28	4494982.79			

İli : TRABZON
İlçesi : ARAKLI
Mahallesi : BAHÇECİK

RÖLEVE KROKİSİ

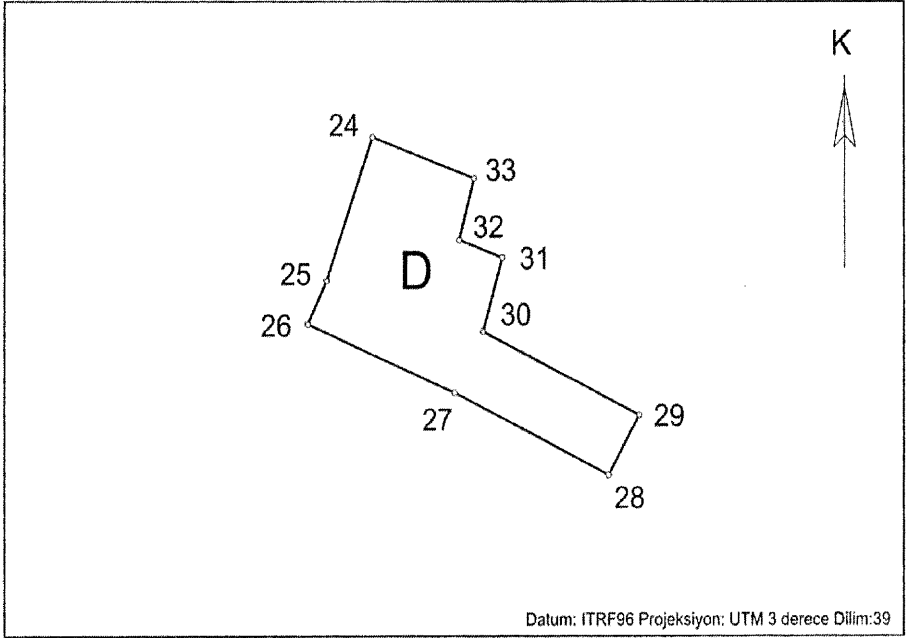

Ada	Parsel	Noktalar	HesapAlan
101	1-D	24,33,32,31,30,29,28,27,26,25	287.59

NoktaNo	Y	X	NoktaNo	Y	X
24	584155.81	4494662.49	25	584151.71	4494651.23
26	584150.07	4494647.83	27	584163.09	4494642.40
28	584176.54	4494635.92	29	584179.22	4494640.63
30	584165.56	4494647.23	31	584167.23	4494653.04
32	584163.47	4494654.42	33	584164.76	4494659.25

İli : TRABZON
İlçesi : ARAKLI
Mahallesi : BAHÇECİK

RÖLEVE KROKİSİ

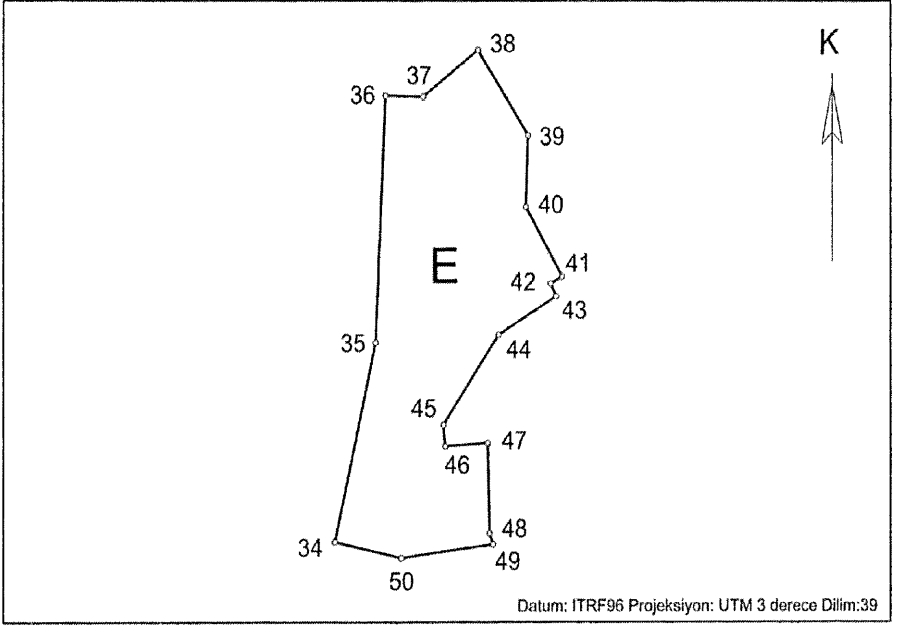

Datum: ITRF96 Projeksiyon: UTM 3 derece Dilim:39

Ada	Parsel	Noktalar	HesapAlan
101	1-E	36,37,38,39,40,41,42,43,44,45, 46,47,48,49,50,34,35	866.63

NoktaNo	Y	X	NoktaNo	Y	X
34	584262.21	4494505.82	35	584267.18	4494527.76
36	584268.40	4494555.02	37	584273.00	4494554.91
38	584279.67	4494560.03	39	584285.75	4494550.64
40	584285.48	4494542.76	41	584289.90	4494535.03
42	584288.48	4494534.25	43	584289.17	4494532.89
44	584282.18	4494528.63	45	584275.44	4494518.72
46	584275.67	4494516.40	47	584280.85	4494516.76
48	584281.09	4494506.79	49	584281.51	4494505.57
50	584270.32	4494504.05			

İli : TRABZON
İlçesi : ÇAYKARA
Köyü : ULUCAMI

RÖLEVE KROKİSİ

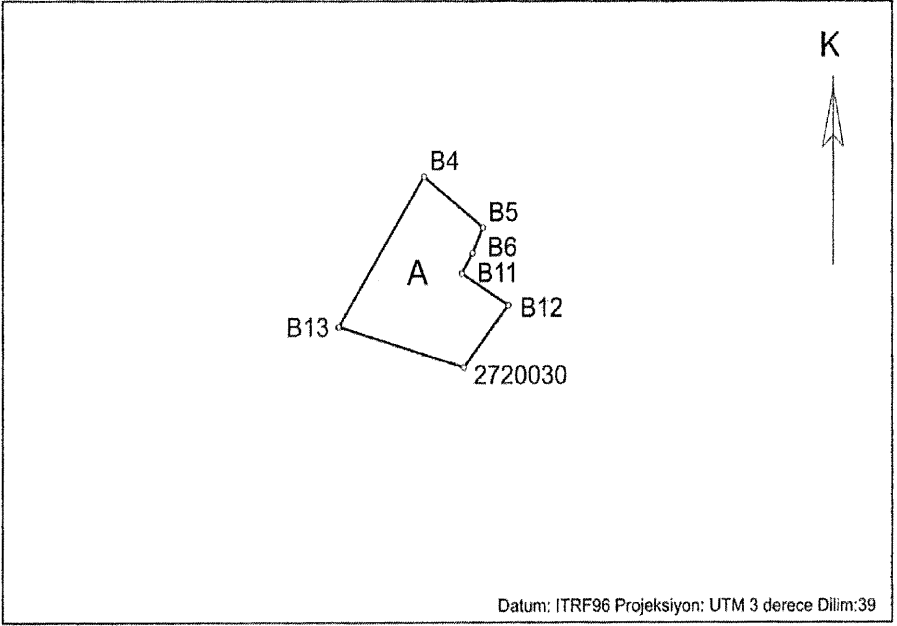

Ada	Parsel	Noktalar	HesapAlan
106	1-A	B4,B5,B6,B11,B12,2720030,B13	113.77

NoktaNo	Y	X	NoktaNo	Y	X
2720030	606638.84	4516152.62	B4	606635.43	4516167.56
B5	606640.49	4516163.57	B6	606639.61	4516161.55
B11	606638.66	4516159.96	B12	606642.67	4516157.48
B13	606628.06	4516155.81			

İli : TRABZON
İlçesi : OF
Mahallesi : İRFANLI

RÖLEVE KROKİSİ

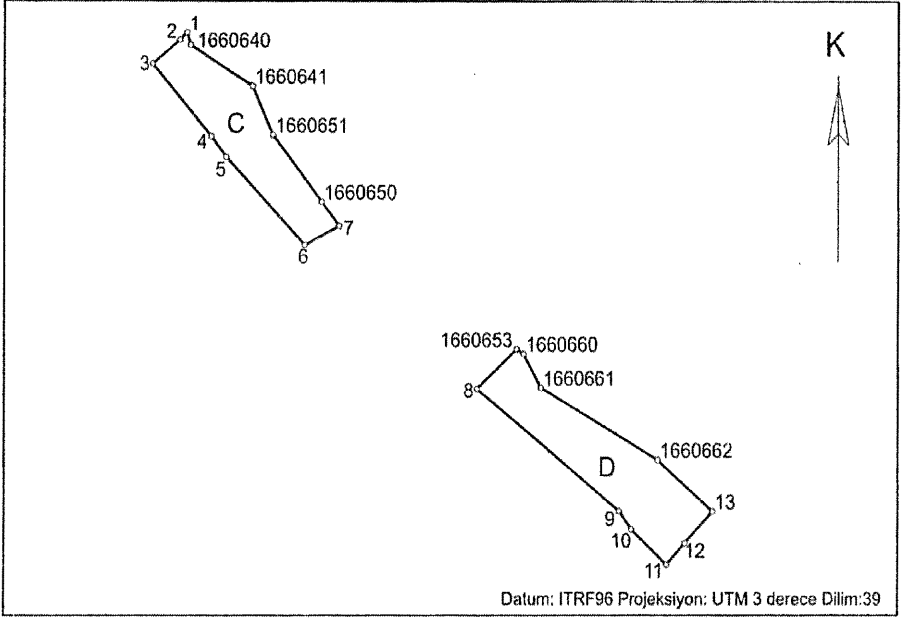

Ada	Parsel	Noktalar	HesapAlan
166	37-C	1,1660640,1660641,1660651, 1660650,7,6,5,4,3,2	542.63
166	37-D	8,1660653,1660660,1660661, 1660662,13,12,11,10,9	674.31

NoktaNo	Y	X	NoktaNo	Y	X
1	605821.13	4534353.60	2	605819.54	4534352.09
3	605813.32	4534347.21	4	605826.56	4534332.29
5	605829.93	4534328.06	6	605847.35	4534310.07
7	605855.03	4534313.95	8	605885.70	4534280.41
9	605917.70	4534255.45	10	605920.46	4534251.66
11	605928.36	4534244.38	12	605932.45	4534248.82
13	605938.65	4534255.36	1660640	605821.94	4534351.04
1660641	605835.70	4534342.61	1660650	605851.13	4534318.88
1660651	605840.26	4534332.60	1660653	605894.61	4534288.56
1660660	605896.16	4534287.62	1660661	605900.03	4534280.63
1660662	605926.41	4534265.85			

İli : TRABZON
İlçesi : OF
Mahallesi : SOĞUKPINAR

RÖLEVE KROKİSİ

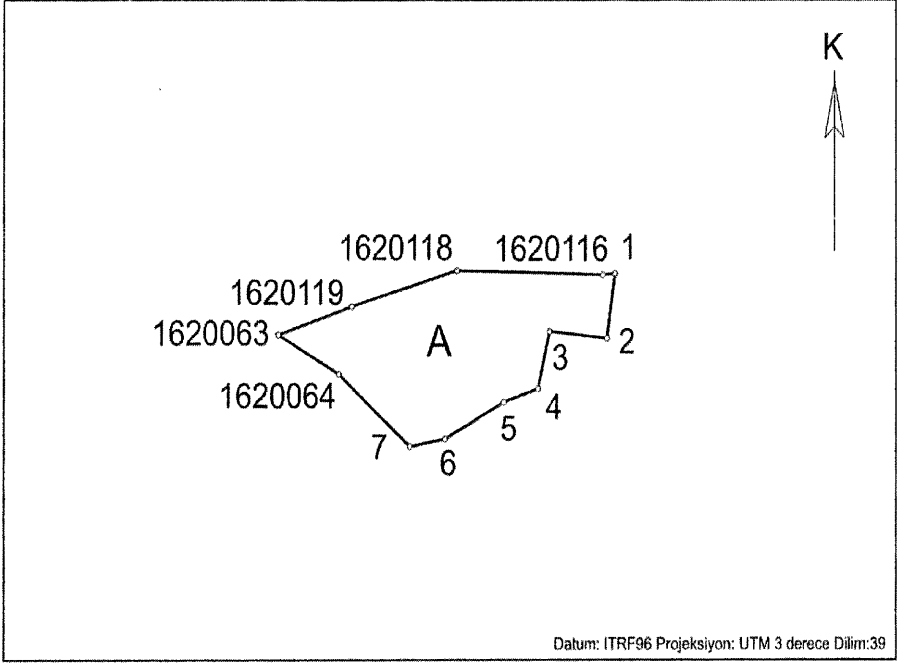

Ada	Parsel	Noktalar	HesapAlan
162	30-A	1,2,3,4,5,6,7,1620064,1620063, 1620119,1620118,1620116	241.97

NoktaNo	Y	X	NoktaNo	Y	X
1	604118.12	4533531.75	2	604117.39	4533526.63
3	604112.06	4533527.18	4	604110.99	4533522.67
5	604107.84	4533521.62	6	604102.45	4533518.69
7	604099.22	4533518.11	1620063	604086.97	4533526.92
1620064	604092.60	4533523.83	1620116	604116.99	4533531.65
1620118	604103.54	4533531.98	1620119	604093.82	4533529.16

İli : TRABZON
İlçesi : TONYA
Mahallesi : İSKENDERLİ

RÖLEVE KROKİSİ

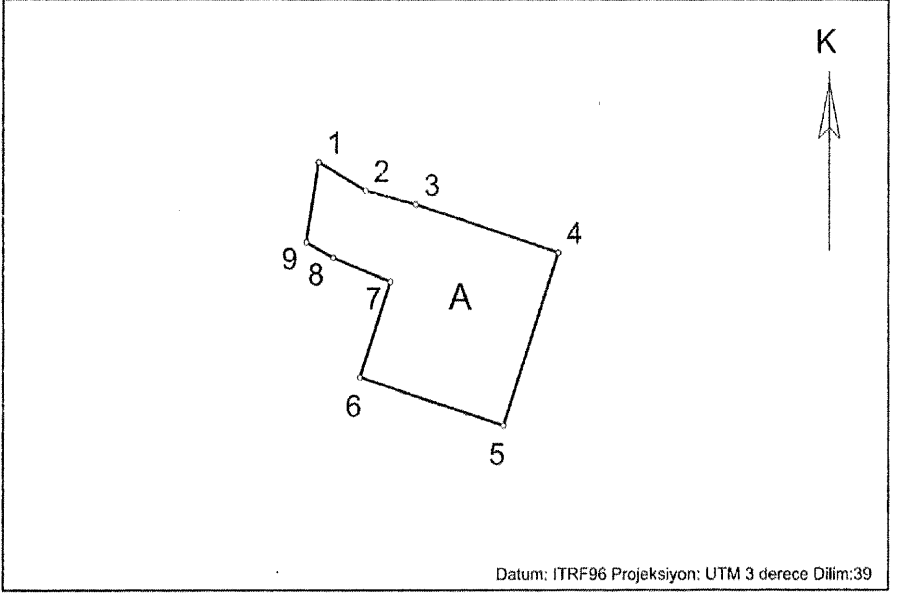

Datum: ITRF96 Projeksiyon: UTM 3 derece Dilim:39

Ada	Parsel	Noktalar	HesapAlan
423	24-A	4,5,6,7,8,9,1,2,3	120.66

NoktaNo	Y	X	NoktaNo	Y	X
1	521491.45	4531278.48	2	521494.28	4531276.86
3	521497.31	4531276.07	4	521505.91	4531273.31
5	521502.58	4531263.45	6	521493.95	4531266.21
7	521495.80	4531271.65	8	521492.31	4531273.01
9	521490.70	4531273.90			

İli : YALOVA
İlçesi : MERKEZ
Köyü : KIRAZLI

RÖLEVE KROKİSİ

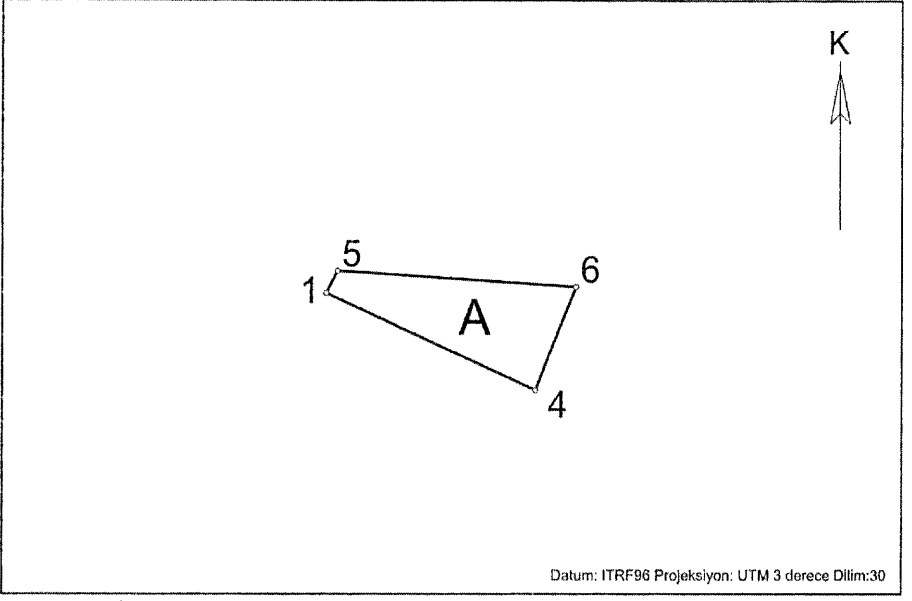

Ada	Parsel	Noktalar	HesapAlan
212	1-A	1,5,6,4	203.21

NoktaNo	Y	X	NoktaNo	Y	X
1	439757.41	4496810.00	4	439781.90	4496799.12
5	439758.74	4496812.48	6	439786.62	4496810.69